

Soils Map

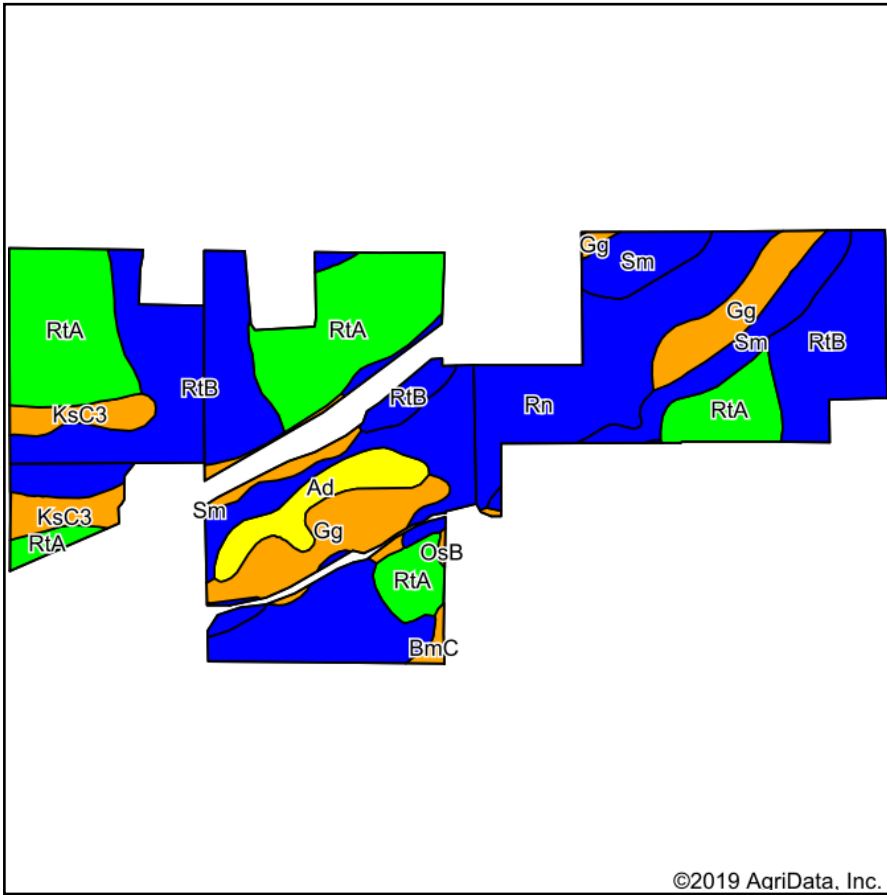

Soils data provided by USDA and NRCS.

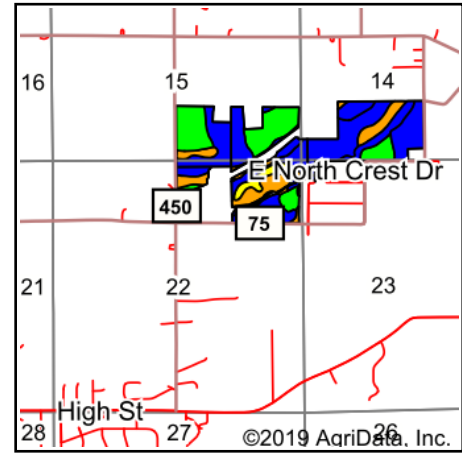

State: **Indiana**
 County: **Cass**
 Location: **15-27N-2E**
 Township: **Clay**
 Acres: **172.23**
 Date: **3/19/2019**



Area Symbol: IN017, Soil Area Version: 23

Code	Soil Description	Acres	Percent of field	Non-Irr Class Legend	Non-Irr Class *c	Corn	Soybeans	*n NCCPI Soybeans
RtB	Rush silt loam, 2 to 6 percent slopes	54.20	31.5%	[Blue]	Ile	155	54	72
RtA	Rush silt loam, 0 to 2 percent slopes	41.39	24.0%	[Green]	I	155	54	73
Rn	Rensselaer loam, till substratum	32.51	18.9%	[Blue]	IIw	175	49	75
Gg	Gilford loam, gravelly substratum	16.29	9.5%	[Orange]	IIIw	155	35	60
Sm	Sleeth silt loam	12.10	7.0%	[Blue]	IIw	140	45	72
KsC3	Kosciusko sandy clay loam, 6 to 12 percent slopes, severely eroded	8.40	4.9%	[Orange]	IIIe	95	33	23
Ad	Ackerman muck, drained	6.37	3.7%	[Yellow]	IVw	144	35	63
BmC	Bloomfield loamy fine sand, 4 to 12 percent slopes	0.70	0.4%	[Orange]	IIIe	85	30	36
OsB	Ormas loamy fine sand, 2 to 6 percent slopes	0.27	0.2%	[Orange]	IIIe	110	39	38
Weighted Average						154	48.8	*n 68.7

*n: The aggregation method is "Weighted Average using major components"

*c: Using Capabilities Class Dominant Condition Aggregation Method

Soils data provided by USDA and NRCS.