

PUBLIC AUCTION



SALE CATALOG

Online Only Auction

DIRECT MAIL, DISTRIBUTION CENTER & HEADQUARTERS

3725 Alexandria Pike, Cold Spring, KY 41076



BIDDING ENDS: THURS., AUGUST 19, 2021 - 9:00 AM

Auctioneers:

Jeffrey L. Luggen - License # RP7066

Joseph M. Luggen - License # RP3521

18% BUYER'S PREMIUM IS IN EFFECT FOR THIS SALE!

ALTHOUGH INFORMATION HAS BEEN OBTAINED FROM SOURCES DEEMED RELIABLE, THE AUCTIONEER MAKES NO WARRANTY FOR GUARANTEE EXPRESSED OR IMPLIED, AS TO THE ACCURACY OF THE INFORMATION HEREIN CONTAINED. IT IS FOR THIS REASON THAT BUYERS SHOULD AVAIL THEMSELVES FOR THE OPPORTUNITY TO MAKE INSPECTION PRIOR TO THE SALE.



Sale Under the Management of

CINCINNATI **INDUSTRIAL AUCTIONEERS**

auctioneers | appraisers | since 1961 | cia-auction.com | info@cia-auction.com
2020 Dunlap St., Cincinnati, Ohio 45214 Phone 513-241-9701 Fax 513-241-6760

SYNOPSIS OF THE TERMS OF SALE
DIRECT MAIL, DISTRIBUTION CENTER & HEADQUARTERS
3725 Alexandria Pike, Cold Spring, KY 41076
THURSDAY, AUGUST 19, 2021 – 90:00 AM

REGISTRATION: All Bidders must register at www.bidspotter.com and complete the bidder registration form, removal agreement, sales tax exemption form and COVID-19 statement sent by the Auctioneer after registering for the auction.

“AS IS, WHERE IS”: Everything is being sold for cash on an “as is”, “where is” basis without warranties expressed or implied on part of the Owner and Auctioneer. There are NO REFUNDS, NO EXCHANGES, NO GUARANTEES or NO WARRANTIES on any item.

ALL SALES ARE FINAL. All Items are sold on a “Where Is” basis with the Purchaser to incur all costs in conjunction with the loading, shipping, and removal of the items from the premises.

DEPOSITS: The Auctioneer may request a deposit at time of registration.

PAYMENTS: ALL INVOICES MUST BE PAID IN FULL WITHIN 24 HOURS AFTER THE AUCTION. Any merchandise not paid for by this specified time will be considered abandoned and may be resold by the auctioneer, any loss incurred in the resale to be borne by the original buyer. All payments must be made by **check or certified funds by express mail, wire transfer or ACH.** Please inquire with auction personnel regarding the acceptance of funding. **NO ONSITE PAYMENTS OR CREDIT CARDS WILL BE ACCEPTED.**

REMOVAL: All Bidders must execute the COVID-19 Health Screening Questionnaire & Self Declaration Sheet. All Bidders must comply with Social Distancing Policies and any other policies as requested by DAV and the state of Kentucky. All bidders removing their items will be required to wear a face mask.

ALL LARGE ITEMS MUST BE OFF THE PREMISES BY FRIDAY, AUGUST 27, 2021 at 4:00 PM.

At which time the Auctioneer’s representative will leave the premises. After this time, arrangements for removal must be made with the “ERRA” Hosea Project Movers.

“TIME IS OF THE ESSENCE” ALL ITEMS MUST BE OFF THE PREMISES BY WEDNESDAY, SEPTEMBER 1, 2021 at 4:00 PM.

At the Owners Discretion, any items remaining after this time will be removed from the premises and stored at the expense of the buyer, considered abandoned and scrapped.

REMOVAL & RIGGING

THE EXCLUSIVE RIGGER & REMOVAL AGENT, (“ERRA”) FOR THIS AUCTION IS:

Hosea Project Movers, David Wissel | 513-652-9152 | davidw@hosea.com

Hosea Project Movers is the “ERRA” is the only company authorized to rig, dismantle, and load equipment at the DAV Auction Site. Loading charges for items will be listed in the auction catalog where available. Loading charges are for simple lift & load only, any special preparations will be an additional charge and need to be arranged with “ERRA”. All payments for the loading charges and any loading arrangements must be made directly with “ERRA.” Some items are listed as “loading charge TBD, (To Be Determined).” Loading charges for these items must be negotiated directly with the “ERRA.” Removal arrangements other than those stated herein must be made directly with the Auctioneer and the “ERRA”. **Loading prices are valid until September 1, 2021.**

CHECKOUT HOURS:

Friday, August 20th From 8:00 AM to 4:00 PM

Monday, August 23rd – Friday, August 27th From 8:00 AM to 4:00 PM

Monday, August 30th – Wednesday, September 1st By Appointment Only!!

IMPORTANT AUCTION NOTICES:

18% BUYERS PREMIUM IS IN EFFECT FOR ALL PURCHASES!

ALL BUYERS WILL BE REQUIRED TO EXECUTE AN “AUCTION PURCHASE REMOVAL AGREEMENT”

ALL SALES SUBJECT TO STATE AND LOCAL SALES TAX WHERE APPLICABLE

ALL BIDDERS MUST COMPLY WITH OUR CUSTOMARY “TERMS OF SALE” ATTACHED HERETO,

POSTED AT THE SALE SITE & OUR WEBSITE @ WWW.CIA-AUCTION.COM.

Auctioneer Can Not Assist with Export Documents!

WIRING INSTRUCTIONS

Call for Complete Wire Transfer Instructions

PLEASE SPECIFY YOUR BIDDER NUMBER WHEN MAKING YOUR WIRE TRANSFER

NOTE: A BANK WIRE TRANSFER FEE WILL APPLY WHICH IS NOT INCLUDED IN BALANCE DUE OF INVOICE



CINCINNATI INDUSTRIAL AUCTIONEERS
auctioneers | appraisers | since 1961 | cia-auction.com | info@cia-auction.com
2020 Dunlap St., Cincinnati, Ohio 45214 Phone 513-241-9701 Fax 513-241-6760

TERMS OF SALE

NOTICE: All Bidders and other persons attending this sale (“Bidders”) agree that they have read and have full knowledge of these terms and agree to be bound hereby. The Bidder identified by the Auctioneer as the high bidder or successful bidder at auction (“successful Bidder”) shall have entered into a legally binding contract to purchase the item bid upon (“Lot”) at the price and subject to the terms and conditions set forth herein. All determinations, rulings, and adjustments made by the Auctioneer in good faith shall be final, binding, and conclusive upon all Bidders. The term “Auctioneer” herein means Cincinnati Industrial Auctioneers, Inc.

1. **IDENTIFICATION** - All Bidders are required to give full name and addresses at time of registration.
2. **DEPOSIT** - Each successful Bidder will be required to make a deposit in cash or by bank cashier’s or certified check of 25 percent (25%) of the successful bid on each Lot at time of knockdown. In default of such deposit, the Lot may be put up again immediately and resold.
3. **TIME OF PAYMENT** – Each successful Bidder shall receive an invoice during or at the conclusion of the auction. All invoices must be paid in full by the close of business on the last day of the auction sale and prior to removing any Lot. Any other arrangements must be made with auctioneer prior to bidding. In the absence of payment or agreement by the auctioneer, title to the Lot shall not transfer to the successful Bidder and such Bidder will lose any right, title or interest such Bidder may have acquired, and the deposit paid, if any, without further notice to such Bidder. The Bidder shall nonetheless remain liable for any damages caused by the Bidder’s failure to pay.
4. **REMOVAL** - All purchases must be removed not later than the date specified in the Auction Catalogue and/or announced at the sale. No Lot can, on any account, be removed during the sale. All goods are sold “Where Is.” Removal shall be at the expense, risk, and liability of the successful Bidder. Purchases will be released only on presentation of paid invoice. Auctioneer shall not be responsible for Lots not removed within the time allowed, but Auctioneer shall have the option to remove and store at the expense and risk of the successful Bidder any article purchased, but not paid for and removed within the time required.
5. **MANNER OF PAYMENT** – All payments must be made by cash, bank cashier’s check or company check with a bank letter of authorization guaranteeing funds to “Cincinnati Industrial Auctioneers, Inc.” All checks for deposits and balances due shall be payable to the order of “Cincinnati Industrial Auctioneers, Inc.” All invoices must be paid to representatives of the Auctioneer at the auction site unless otherwise announced. The full purchase price on all Lots sold to the same successful Bidder must be paid within the time fixed and before removal of any Lot.
6. **DISCALIMER OF ALL WARRANTIES INCLUDING IMPLIED WARRANTIES OF MERCHANTABILITY AND FITNESS FOR PARTICULAR PURPOSE; CONDITION OF ARTICLES SOLD – The Auctioneer and any owner, seller, or secured party make no warranties express or implied as to merchantability or fitness for purpose whatsoever. All such express or implied warranties are expressly excluded hereby. No oral statement or other writing by any person negates this exclusion. If you think you have received any assurance or warranty of any kind as to a Lot offered in this auction do not bid on such item unless the Auctioneer has signed a writing specifically directed to you and identifying the Lot and stating the modification of this exclusion The Auctioneer shall not be responsible for the correct description, genuineness, authenticity of, or defect in any Lot, and makes no warranty in connection therewith. No sale will be set aside nor allowance made on account of any incorrectness, error in commentary, cataloging, or any imperfection not noted. No deduction, credit or avoidance shall be allowed on damaged articles, all Lots being exposed for public exhibition are purchased and accepted by successful Bidder “AS IS”, “WHERE IS” and “WITH ALL FAULTS”. Auctioneer makes no warranties or guarantees whatsoever whether written, oral or implied as to quality, quantity, condition, usability, salability, weight, measurement, age, model, mechanical condition, performance or other specifications and all sales made are utterly without recourse.**
7. **CLAIMS** – No Claims will be allowed after removal of Lots from premises.
8. **RESPONSIBILITY FOR NON-DELIVERY**- Auctioneer, any owner, seller or secured party shall not, in any event, be liable to any Bidder for non-delivery of any Lot or for any other matter or thing, other than for the return to the successful Bidder of the deposit or sum paid on said Lot, should the successful Bidder be entitled thereto. This means that if are a successful Bidder and for any reason your Lot is not made available to you, you agree that the damages you may claim for such non-delivery are limited to the amounts you have paid and you waive any



CINCINNATI INDUSTRIAL AUCTIONEERS
auctioneers | appraisers | since 1961 | cia-auction.com | info@cia-auction.com
2020 Dunlap St., Cincinnati, Ohio 45214 Phone 513-241-9701 Fax 513-241-6760

claim for damages for lost profits, opportunity, the value of the Lot in excess of the purchase price, your time, expenses, incidental and consequential damages, all of which are expressly waived.

9. **COMPLIANCE WITH TERMS OF SALE** – In default of payment of invoices in full within the time therein specified, the Auctioneer in addition to all other remedies allowed by law, may retain all monies received as deposit or otherwise, as liquidated damages. Lots not paid for and removed within the time allowed herein may be resold at public or private sale without further notice, and any deficiency, together with all expenses and charges of resale, will be charged to the defaulting successful Bidder.
10. **RISK TO PERSON AND PROPERTY** – Persons attending during exhibition, sale, or removal of Lots assume all risks of damage of or loss to person and property and specifically release the Auctioneer from liability therefore and agree to indemnify and hold the Auctioneer harmless from any loss, claim, liability, cost, or expense caused all or in part by such person(s). Neither the auctioneer nor his principal shall be liable by reason of any defect in or condition of the premises on which the exhibition, sale, or removal of Lots is held.
11. **ADDITION TO OR WITHDRAWAL FROM SALE** – The Auctioneer reserves the right to alter the order of the sale, withdrawal from the sale any of the Lots or parts thereof or to sell at this sale Lots not listed, and also reserves the right to group one or more Lots into one or more selling Lots or to subdivide into two or more selling Lots, or make any combination thereof which Auctioneer in its sole discretion determines. Whenever the best interest of the Seller will be served, the Auctioneer reserves the right to sell Lots in bulk.
12. **SALE BY ESTIMATED WEIGHT, COUNT OR MEASURE** – Where items are sold by estimated weight, count, or measure, the successful Bidder will be invoiced for and required to pay for the estimated weight, count, or measure. If upon delivery any shortage exists, the successful Bidder will receive a credit at the rate of the bid. If there be an excess, the successful Bidder will be required to take and pay for such excess, at the rate of the bid.
13. **DISPUTE BETWEEN BIDDERS/BID INCREMENTS** – If any dispute arises between two or more Bidders, the Auctioneer may decide the same or put the Lot up for sale again at once or resell to the highest Bidder. The Auctioneer may reject a nominal or fractional bid advance in the Auctioneer's sole discretion.
14. **RESERVE** – The Auctioneer reserves the right to reject any and all bids. On Lots upon which there is a reserve, the Auctioneer shall have the right to bid on behalf of the seller, owner or secured party and shall have no obligation to denote or announce such reserve or bid.
15. **RECORDS** – The record of sale kept by the Auctioneer and bookkeeper will be taken as final in the event of any dispute.
16. **AGENCY** – The Auctioneer is acting as agent only and is not responsible for the acts of its principals.
17. **SALES TAX** – All sales are subject to state and local taxes, which will be collected from the successful Bidder unless a proper exemption certificate including tax-exempt number is presented at the time of payment.
18. **BUYER'S PREMIUM** – The Auctioneer in its sole discretion may impose a Buyer's Premium on any Lots sold. The Buyer's Premium is a percentage that is added to the final purchase price of any Lot.
19. **SHIPPING** – All coolants, oil and fluids must be drained from all machinery and equipment prior to removal. All of the above must be shipped in compliance with state and federal regulations. Unless otherwise expressly provided in writing, preparation and shipment shall be at the sole responsibility and cost of the successful Bidder.
20. **INSURANCE** – All successful Bidders, or their riggers must provide the Auctioneer and the owner of the premises of the sale a certificate of insurance in amounts acceptable to the Auctioneer prior to removal of any Lot.
21. **ADDITIONAL TERMS AND CONDITIONS** – Except as set forth in Section 6 above, the Auctioneer may modify or supplement these terms and conditions of sale by language in the catalog available at the sale site or by announcement at the start of the sale.



CINCINNATI INDUSTRIAL AUCTIONEERS
auctioneers | appraisers | since 1961 | cia-auction.com | info@cia-auction.com
2020 Dunlap St., Cincinnati, Ohio 45214 Phone 513-241-9701 Fax 513-241-6760

AUCTION PURCHASE & REMOVAL AGREEMENT

DIRECT MAIL, DISTRIBUTION CENTER & HEADQUARTERS

3725 Alexandria Pike, Cold Spring, KY 41076

THURSDAY, AUGUST 19, 2021 – 9:00 AM

All purchasers of items at the Direct Mail, Distribution Center & Headquarters auction conducted by Cincinnati Industrial Auctioneers, Inc. hereby agree to the following:

All purchasers agree to abide by the “Terms of Sale” as listed on our website and posted at the auction premises. The Auctioneer and Owner make no warranties express or implied as to merchantability, fitness for purpose, or condition of the articles being sold. All such expressed or implied warranties are expressly excluded hereby. All Bidders must execute the COVID-19 Health Screening Questionnaire & Self Declaration Sheet. All Bidders must comply with Social Distancing Policies and any other policies as requested by DAV and the state of Kentucky. Any bidder removing items will be required to wear a face mask.

All items are purchased on an “As Is, Where Is” basis, with the purchaser to incur all costs in conjunction with the loading, shopping and removal of the items from the premises. ALL EQUIPMENT MUST BE REMOVED IN A WORKMAN LIKE MANNER AND ALL UTILITIES MUST BE CAPPED. ALL ANCHOR BOLTS MUST BE CUT OFF AT FLOOR LEVEL. ALL OILS AND COOLANTS MUST BE REMOVED FROM MACHINES PRIOR TO REMOVAL. All items are available for removal during normal business hours through **Friday, August 27, 2021 at 4:00 PM** at which time our representatives will leave the premises. After this time arrangements for removal must be made by appointment with “ERRA”, Hosea Project Movers.

“TIME IS OF THE ESSENCE” regarding the removal of items from the premises. All items must be removed by **Wednesday, September 1, 2021 at 3:00 PM**. Any items remaining after this time will be removed and stored at the expense of the buyer or considered abandoned and scrapped. NO EXCEPTIONS!

REMOVAL & RIGGING

THE EXCLUSIVE RIGGER & REMOVAL AGENT, (“ERRA”) FOR THIS AUCTION IS:

Hosea Project Movers, David Wissel | 513-652-9152 | davidw@hosea.com

Hosea Project Movers is the “ERRA” is the only company authorized to rig, dismantle, and load equipment at the DAV Auction Site. Loading charges for items will be listed in the auction catalog where available. Loading charges are for simple lift & load only, any special preparations will be an additional charge and need to be arranged with “ERRA”. All payments for the loading charges and any loading arrangements must be made directly with “ERRA.” Some items are listed as “loading charge TBD, (To Be Determined).” Loading charges for these items must be negotiated directly with the “ERRA.” Removal arrangements other than those stated herein must be made directly with the Auctioneer and the “ERRA”. **Loading prices are valid until September 1, 2021.**

There are NO REFUNDS, NO EXCHANGES, NO GUARANTEES OR NO WARRANTIES on any item. **ALL SALES ARE FINAL.**

Accepted By Purchaser:

Company Name

Buyer Number / Bidspotter Email

Signature

Date

Direct Mail, Distribution & Headquarters
August 19, 2021



CINCINNATI INDUSTRIAL AUCTIONEERS
auctioneers | appraisers | since 1961 | cia-auction.com | info@cia-auction.com
2020 Dunlap St., Cincinnati, Ohio 45214 Phone 513-241-9701 Fax 513-241-6760

OFFICE LOT LOCATOR MAP

FRONT LOBBY

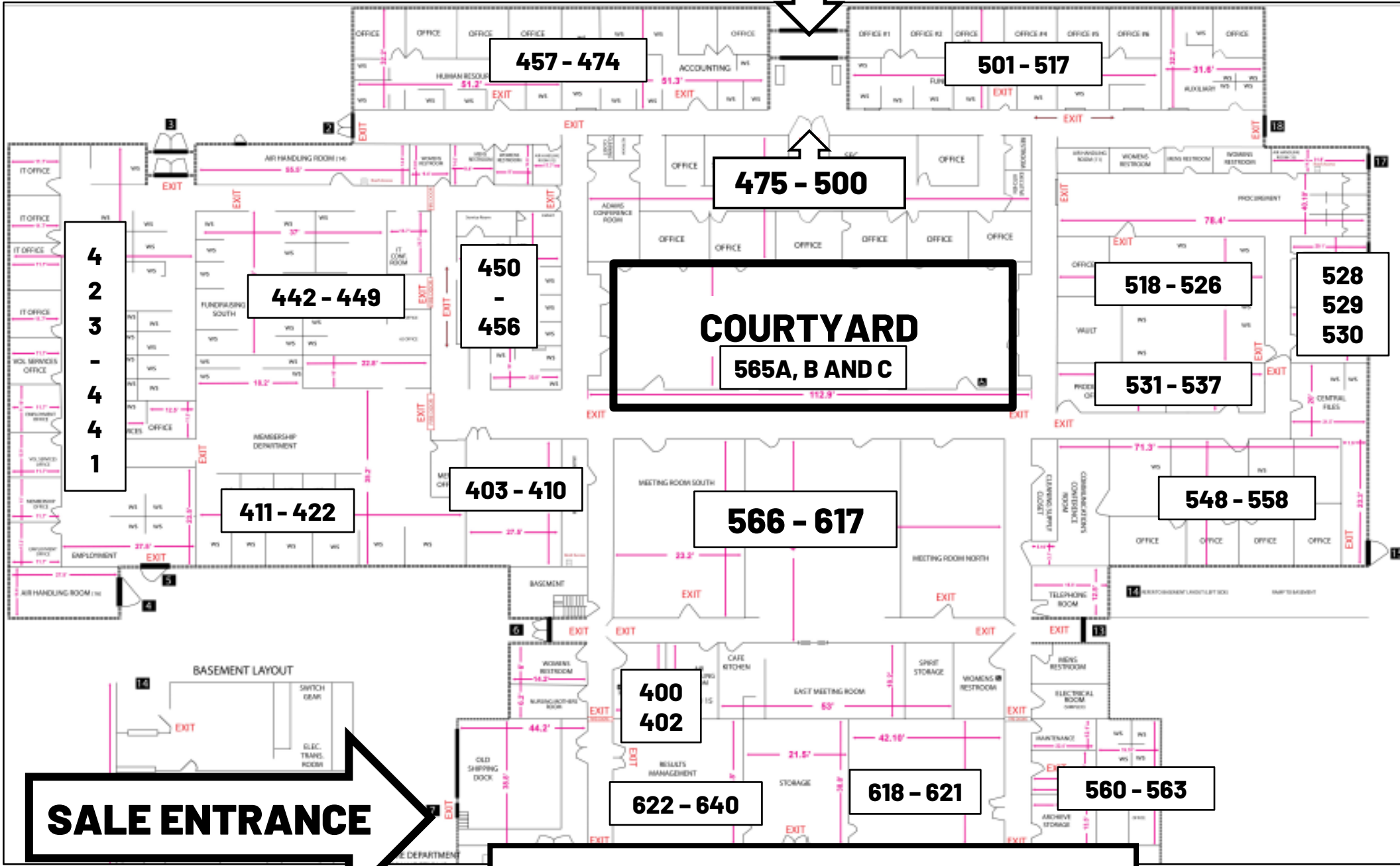

SALE ENTRANCE

PLANT / WAREHOUSE AREA

Catalog for Auction: Direct Mail, Distribution Center

This catalog is meant merely as a guide. The Auctioneers do not warrant the accuracy, genuineness, authenticity, description, weight, count or measure of any of the lots specified herein.

Lot Num	Qty.	Description	Lot Num	Qty.	Description
1	1	(LOT) (4) ELECTRIC TOOLS INCLUDING (2) DRILLS STRAIGHT GRINDER	26	1	15" ROCKWELL 15-655 FLOOR DRILL **Loading Fee Due the "ERRA" Hosea Project Movers \$75.00, SEE PRICING SPECIFICS**
2	1	(LOT) MISCELLANEOUS TOOLS AND TOOL BOX	27	1	6" X 18" SUNNY MODEL SGS-618 HAND FEED SURFACE GRINDER, COOLANT S/N 8402082 **Loading Fee Due the "ERRA" Hosea Project Movers \$100.00, SEE PRICING SPECIFICS**
3	1	(LOT) MISCELLANEOUS INSPECTION TOOLS	28	1	DUNCAN MODEL DK820-1 CERAMIC ELECTRIC KILN **Loading Fee Due the "ERRA" Hosea Project Movers \$75.00, SEE PRICING SPECIFICS**
4	1	METRIC TAP AND DIE SET	29	1	30 TON RAMCO MODEL RP-30 H-FRAME PRESS; S/N 03177 **Loading Fee Due the "ERRA" Hosea Project Movers \$75.00, SEE PRICING SPECIFICS**
5	1	(LOT) (2) 3" VISES	30	1	90" X 20" X 36" STOCK RACK WITH CONTENTS
6	1	(LOT) (2) EAGLE WELD MODEL UT-236 SPLICE KITS	31	1	60 GALLON JUSTRITE "FIREPROOF" CABINET **Loading Fee Due the "ERRA" Hosea Project Movers \$75.00, SEE PRICING SPECIFICS**
7	1	(LOT) (2) EAGLE WELD MODEL UT-236 SPLICE KITS	32	1	20 GALLON SE-CUR-ALL "FIREPROOF" CABINET **Loading Fee Due the "ERRA" Hosea Project Movers \$50.00, SEE PRICING SPECIFICS**
7A	1	HABASIT BELT SPLICE KIT	33	1	6-DRAWER EQUIPTO CABINET WITH MISCELLANEOUS FOLDER PARTS **Loading Fee Due the "ERRA" Hosea Project Movers \$50.00, SEE PRICING SPECIFICS**
8	1	(LOT) MISCELLANEOUS PUNCH SETS INCLUDING KNOCKOUT, NUMBERS, & LETTERS	34	1	6-DRAWER EQUIPTO CABINET WITH MISCELLANEOUS MACHINE PARTS **Loading Fee Due the "ERRA" Hosea Project Movers \$50.00, SEE PRICING SPECIFICS**
9	1	3 HP CRAFTSMAN PORTABLE AIR COMPRESSOR, 250 VOLT, 3-PRONG TWIST PLUG	35	1	(LOT) MISCELLANEOUS LAWSON HARDWARE BINS WITH MISCELLANEOUS HARDWARE **Loading Fee Due the "ERRA" Hosea Project Movers \$50.00, SEE PRICING SPECIFICS**
10	1	150 PSI/6 GALLON PORTER CABLE PORTABLE AIR COMPRESSOR	36	1	8-DRAWER HARDWARE CABINET WITH MISCELLANEOUS HARDWARE **Loading Fee Due the "ERRA" Hosea Project Movers \$50.00, SEE PRICING SPECIFICS**
11	1	150 PSI/6 GALLON PORTER CABLE PORTABLE AIR COMPRESSOR	37	1	48" X 32" WOOD BENCH WITH (2) MICROWAVE OVENS AND TOASTER
12	1	8" AMROX DE GRINDER			
13	1	6" BENCH VISE			
14	1	PETER WRIGHT ANVIL, NO. 0-3-16			
15	1	96" X 36" MAPLE TOP BENCH WITH 4" VISE			
16	1	68" X 32" MAPLE TOP BENCH WITH 4" VISE			
17	1	(LOT) (4) SHOP VACS			
18	1	8" MILWAUKEE DE GRINDER			
19	1	6" CRAFTSMAN DE GRINDER			
20	1	12" JEFFERSON ELECTRIC HACK SAW			
21	1	76" X 30" MAPLE TOP BENCH			
22	1	1.5 KVA DAYTON SPOT WELDER, 12" THROAT, FOOT PEDAL			
23	1	10" X 40" ROCKWELL ENGINE LATHE, 8" CHUCK **Loading Fee Due the "ERRA" Hosea Project Movers \$250.00, SEE PRICING SPECIFICS**			
24	1	3/4 HP ROCKWELL UNIVERSAL MILL, HORIZONTAL AND VERTICAL MILLING, 6.5" X 24" TABLE, 60-2400 RPM SPINDLE SPEED **Loading Fee Due the "ERRA" Hosea Project Movers \$150.00, SEE PRICING SPECIFICS**			
25	1	4" PALMGREN MACHINE VISE			

Catalog for Auction: Direct Mail, Distribution Center

Lot Num	Qty.	Description	Lot Num	Qty.	Description
38	1	6-DRAWER CABINET WITH	71	6	36" X 30" 8-SHELF STEEL CARTS
		MISCELLANEOUS TOOLING **Loading Fee	72	6	36" X 30" 8-SHELF STEEL CARTS
		Due the "ERRA" Hosea Project Movers \$50.00,	73	3	36" X 30" 9-SHELF STEEL CARTS
		SEE PRICING SPECIFICS**	74	4	33" X 30" 8-SHELF STEEL CARTS
39	1	7-DRAWER CABINET WITH	75	6	30" X 28" 8-SHELF STEEL CARTS
		MISCELLANEOUS MACHINE PARTS **Loading	76	6	30" X 28" 8-SHELF STEEL CARTS
		Fee Due the "ERRA" Hosea Project Movers	77	6	30" X 28" 8-SHELF STEEL CARTS
		\$50.00, SEE PRICING SPECIFICS**	78	6	30" X 28" 8-SHELF STEEL CARTS
40	1	OTC SLIDE HAMMER PULLER SYSTEM	79	5	26" X 24" 8-SHELF STEEL CARTS
41	1	PORTABLE PIGEON HOLE CABINET WITH	80	6	26" X 24" 8-SHELF STEEL CARTS
		MISCELLANEOUS TOOLS AND TOOLING	81	5	30" X 24" 8-SHELF STEEL CARTS
		**Loading Fee Due the "ERRA" Hosea Project	82	1	221" X 41" STEEL FRAMED WOOD BENCH
		Movers \$50.00, SEE PRICING SPECIFICS**	83	1	40" HARRIS SEYBOLD CITATION PAPER
		NEXT ROOM			CUTTER WITH (3) SPARE KNIVES, 3-TON
42	1	BLACK & DECKER/DEWALT MODEL			CLAMP PRESSURE **Loading Fee Due the
		3485-TY2 PANEL SAW; S/N 3360037 **Loading			"ERRA" Hosea Project Movers \$350.00, SEE
		Fee Due the "ERRA" Hosea Project Movers			PRICING SPECIFICS**
		\$75.00, SEE PRICING SPECIFICS**			***NEXT ROOM***
43	1	(LOT) (9) SECTIONS 36" WIDE X 24" DEEP X	84	4	SECTIONS 90" X 28" X 96" ADJUSTABLE
		87" HIGH STEEL SHELVES			BEAM PALLET RACK
44	4	36" X 23" 2-SHELF STEEL CARTS	85	1	52" X 252" X 83" HIGH WELDED TOGETHER,
45	4	36" X 23" 2-SHELF STEEL CARTS			PALLET RACK TYPE CAGE WITH 90" X 28" X
46	4	36" X 23" 2-SHELF STEEL CARTS			96" ADJUSTABLE BEAM PALLET RACK
47	4	36" X 24" HERCULES 2-SHELF STEEL CARTS	86	12	SECTIONS 48" WIDE X 21" DEEP X 83" HIGH
48	6	36" X 18" 2-SHELF STEEL CARTS			ADJUSTABLE BEAM DRIVE-IN PALLET RACK,
49	6	36" X 18" 2-SHELF STEEL CARTS			152" HIGH ENTRANCE UPRIGHTS,
50	2	36" X 25" 3-SHELF STEEL CARTS			PARTIALLY DISASSEMBLED **Loading Fee
51	3	42" X 24" 3-SHELF STEEL CARTS			Due the "ERRA" Hosea Project Movers \$780.00,
52	8	40" X 24" 2-SHELF STEEL CARTS			SEE PRICING SPECIFICS**
53	6	36" X 24" LITTLE GIANT 2-SHELF STEEL	87	7	SECTIONS 48" WIDE X 21" DEEP X 83" HIGH
		CARTS			ADJUSTABLE BEAM DRIVE-IN PALLET RACK,
54	3	30" X 16" 2-SHELF STEEL CARTS WITH 4.5"			152" HIGH ENTRANCE UPRIGHTS **Loading
		BENCH VISES			Fee Due the "ERRA" Hosea Project Movers
55	2	30" X 20" 3-SHELF STAINLESS STEEL	88	15	SECTIONS 48" WIDE X 21" DEEP X 83" HIGH
		CARTS			ADJUSTABLE BEAM DRIVE-IN PALLET RACK,
56	2	32" X 21" 3-SHELF STAINLESS STEEL			152" HIGH ENTRANCE UPRIGHTS **Loading
		CARTS			Fee Due the "ERRA" Hosea Project Movers
57	1	(LOT) MISCELLANEOUS STEEL CARTS			\$975.00, SEE PRICING SPECIFICS**
60	6	48" X 36" 2-SHELF WOOD CARTS	89	3	SECTIONS 48" WIDE X 21" DEEP X 83" HIGH
		NEXT ROOM			ADJUSTABLE BEAM DRIVE-IN PALLET RACK,
61	6	36" X 30" 8-SHELF STEEL CARTS			152" HIGH ENTRANCE UPRIGHTS **Loading
62	6	36" X 30" 8-SHELF STEEL CARTS			Fee Due the "ERRA" Hosea Project Movers
63	6	36" X 30" 8-SHELF STEEL CARTS			\$195.00, SEE PRICING SPECIFICS**
64	6	36" X 30" 8-SHELF STEEL CARTS			
65	6	36" X 30" 8-SHELF STEEL CARTS	90	1	****3,225 LB CLARK MODEL TM17 ELECTRIC
66	6	36" X 30" 8-SHELF STEEL CARTS			SIT-DOWN LIFT TRUCK; S/N
67	6	36" X 30" 8-SHELF STEEL CARTS			TM247-0065-6627, 36 VOLT, 2-STAGE MAST
68	6	36" X 30" 8-SHELF STEEL CARTS			76" MAST HEIGHT, 110" LIFT HEIGHT, WITH
69	6	36" X 30" 8-SHELF STEEL CARTS			CHARGER ****Delay Removal - No Pickup Until
70	6	36" X 30" 8-SHELF STEEL CARTS			9/10/2021****

Catalog for Auction: Direct Mail, Distribution Center

Lot Num	Qty.	Description	Lot Num	Qty.	Description
91	1	2,500 LB CROWN MODEL 25SCTF ELECTRIC SIT-DOWN LIFT TRUCK; S/N W-24899, 36 VOLT, 2-STAGE MAST, 82" MAST HEIGHT, 130" LIFT HEIGHT WITH CHARGER	114	1	(LOT) 1-SKID DIAMOND CRYSTAL 50 LB. BAGS
			115	1	(LOT) 1-SKID DIAMOND CRYSTAL 50 LB. BAGS
92	1	2,500 LB YALE MODEL ESC025 ELECTRIC STAND-UP LIFT; S/N A824N08890D, 24 VOLT, 72" MAST HEIGHT, 3-STAGE MAST, 157" LIFT HEIGHT	116	1	(LOT) 1-SKID DIAMOND CRYSTAL 50 LB. BAGS - LOOSE BAGS NOT WRAPPED PROPERLY
			117	1	10,000 LB FAIRBANKS MODEL H90-5150 DIGITAL PLATFORM SCALE; S/N H194009, 48" X 48" PLATFORM **Loading Fee Due the "ERRA" Hosea Project Movers \$75.00, SEE PRICING SPECIFICS**
93	1	2,500 LB CLARK MODEL NST25 ELECTRIC STAND-UP LIFT TRUCK; S/N 245-60-2270-182, 24 VOLT, 2-STAGE MAST, 72" MAST HEIGHT 106" LIFT HEIGHT			
94	1	24 VOLT V-FORCE HFM SERIES CHARGER, by back dock door	118	1	****3.25 CUBIC YARD RUMPKE MODEL R300 HYDAULIC TRASH COMPACTOR; S/N 108****No container, delay pickup until September 3**** **Loading Fee Due the "ERRA" Hosea Project Movers \$TBD, SEE PRICING SPECIFICS**
95	1	4,000 LB CATERPILLAR MODEL NPP40 WALK BEHIND ELECTRIC PALLET TRUCK; S/N 2CL00402, BUILT-IN CHARGER			
96	1	4,000 LB CROWN MODEL 40GPW-4-14 WALK BEHIND ELECTRIC PALLET TRUCK; S/N 7A1G-195, BUILT-IN CHARGER	120	1	150" X 28" ALUMINUM WHEELCHAIR RAMP **Loading Fee Due the "ERRA" Hosea Project Movers \$75.00, SEE PRICING SPECIFICS**
97	1	4,000 LB HYSTER MODEL W40XL WALK-BEHIND ELECTRIC PALLET TRUCK; S/N D135K2425F, WITH CHARGER	120A	1	(LOT) (8) SKIDS CORRUGATED CARDBOARD BOXES AND MISCELLANEOUS SHIPPING SUPPLIES
98	1	3,500 LB MULTITON MODEL 35-27-48 WALK-BEHIND ELECTRIC PALLET TRUCK; S/N 0203769288, BUILT-IN CHARGER	121	1	16" CLARK MODEL 1700 FLOOR STRIPPER
			122	1	(LOT) KIRBY VACUUM, SINGER VACUUM, COMAIR STEAMER, KIRBY CARPET SHAMPOO SYSTEM
98A	1	(LOT) FORK AND EXTENSION SET			
99	1	JLG MODEL 30MVL SELF TRAVELLING ELECTRIC MAN LIFT; S/N 0130009634, 19.5' MAX LIFT HEIGHT, 350 LB CAPACITY, BUILT-IN CHARGER	122A	1	(LOT) GARBAGE CANS
			123	1	(LOT) (2) BASKETS MISCELLANEOUS OFFICE SUPPLIES
100	1	NSS MODEL WRANGLER 26VS WALK-BEHIND FLOOR SCRUBBER; S/N 262610B-3802ANRL, BUILT-IN CHARGER	124	1	(LOT) (4) SKIDS MISCELLANEOUS OFFICE SUPPLIES
101	1	5,500 LB PALLET TRUCK	125	1	(LOT) (3) SKIDS MISCELLANEOUS OFFICE SUPPLIES AND EQUIPMENT
102	1	5,500 LB PALLET TRUCK	126	1	(LOT) (2) CARTS WITH (3) ELECTRIC TYPEWRITERS, CASH REGISTER, CALCULATOR
103	1	DELETE			
106	1	5,500 LB PALLET TRUCK (BAD HYDRAULICS)	127	22	(LOT) ROLLS SIGNATURE SUMMIT MPC1260B PLASTIC BANDING MATERIAL
107	1	5,500 LB PALLET TRUCK (BAD HYDRAULICS)	128	1	(LOT) (7) SKIDS MISCELLANEOUS REAMS OF PAPER AND CORRUGATED BOXES
108	1	5,500 LB PALLET TRUCK (BAD HYDRAULICS)	129	1	RASCAL MODEL 245 ELECTRIC 3-WHEEL SCOOTER; BUILT-IN CHARGER
109	1	32" AUSSIE GAS GRILLE, back dock area			
110	1	32" AUSSIE GAS GRILLE, back dock area	130	1	GOLDEN TECHNOLOGIES COMPANION 3-WHEEL ELECTRIC SCOOTER
111	1	FLOOR JACK, back dock area			
112	1	(LOT) (6) ECONO JACK TRAILER JACKS, back dock area	131	1	(LOT) (4) WHEELCHAIRS
			132	1	(LOT) (3) ADULT WALKERS
113	1	(LOT) 1-SKID SNO-PLOW 50 LB. ICE MELT BAGS	133	1	(LOT) SKID ELECTRICAL SWITCHES
			134	1	(LOT) (2) OVERHEAD DOOR MOTORS

Catalog for Auction: Direct Mail, Distribution Center

Lot Num	Qty.	Description	Lot Num	Qty.	Description
135	1	(LOT) AMERICAN THERMA-FLO MODEL 2070 REFRIGERANT RECOVERY & CHARGING UNIT AND ROBINAIR VACUUM PUMP	166	1	(LOT) (4) MISCELLANEOUS TABLES AND (6) MISCELLANEOUS STEEL FRAME DESKS
136	1	(LOT) (7) TANKS REFRIGERANT R-22 AND R-502	167	1	MISCELLANEOUS FOLDING TABLE
137	1	KENMORE STACKED WASHER AND DRYER **Loading Fee Due the "ERRA" Hosea Project Movers \$75.00, SEE PRICING SPECIFICS**	168	1	(LOT) (7) 48" X 30" STEEL FRAMED TABLES
138	1	2-DOOR WOOD CABINET	169	1	(LOT) (4) WOOD DESKS
139	8	2-DOOR 36" WIDE X 30" HIGH X 12" DEEP STEEL WALL CABINETS	170	1	(LOT) (4) FANS, (1) 24" PEDASTAL FAN AND (3) 32" WALL FANS
140	1	(LOT) (5) 2 AND 4 DRAWER LATERAL CABINETS, on (2) skids	171	1	(LOT) (7) SKIDS MISCELLANEOUS CARPET, TILE, AND CEILING TILE
141	1	(LOT) (3) 4-DRAWER LATERAL CABINETS	172	1	(LOT) (8) MISCELLANEOUS TABLES
142	1	(LOT) (7) 2-DRAWER LEGAL FILE CABINETS	173	1	(LOT) 84" X 48" CONFERENCE TABLE, CRADENZA, BOOKSHELF
143	1	5-DRAWER SMC CABINET	174	1	(LOT) DESKS AND TABLES
144	10	2-DRAWER LATERAL FILE CABINETS, on (2) skids	175	1	(LOT) (3) MODULAR DESKS
145	10	2-DRAWER LATERAL FILE CABINETS, on (2) skids	176	80	STEEL FRAME AND PLASTIC CAFETERIA CHAIRS
146	1	(LOT) (3) 2 AND 4-DRAWER LATERAL CABINETS	177	7	OFFICE CHAIRS (ALL SAME)
147	1	(LOT) 2-DOOR CABINET, BOOKSHELF, 2-DRAWER CABINET	178	1	(LOT) (6) OFFICE CHAIRS
148	5	2-DRAWER LATERAL CABINETS	179	1	(LOT) (7) OFFICE CHAIRS
149	11	3-DRAWER CABINETS	180	5	CLOTH ARM CHAIRS (ALL SAME)
150	2	3-DRAWER LATERAL CABINETS	181	1	(LOT) (3) CLOTH CHAIRS
151	1	4-DRAWER MEILINK HERCULES FIREPROOF CABINET **Loading Fee Due the "ERRA" Hosea Project Movers \$50.00, SEE PRICING SPECIFICS**	182	1	(LOT) (6) SHIPPING CRATES
152	1	(LOT) (2) SMALL CARTS, LUGGAGE CART, 2-DRAWER CABINET	183	1	(LOT) (14) SHIPPING CRATES
153	2	CAST IRON AND WOOD BENCHES	184	1	(LOT) (2) MISCELLANEOUS COLLAPSIBLE WIRE BASKETS
154	1	(LOT) (8) FATIGUE MATS	185	5	MISCELLANEOUS PORTABLE HAMPERS
155	1	(LOT) STEEL SHELVES	186	1	(LOT) MISCELLANEOUS BENCH AND TABLES
156	1	(LOT) (3) 2 & 4-DRAWER LATERAL CABINETS	186A	1	ROOSEVELT POPCORN POPPER STAND AND STAINLESS STEEL CART
157	4	4-DRAWER CABINETS	187	1	(LOT) MISCELLANEOUS KITCHEN FURNITURE AND APPLIANCES INCLUDING RACKS, CLOCK, COFFEE MAKERS, MICROWAVES, AND DEHUMIDIFIER
158	1	(LOT) (12) 4-DRAWER FILE CABINETS	188	2	4.4 CUBIC FEET MAGIC CHEF REFRIGERATORS (NEW)
159	1	(LOT) (4) MISCELLANEOUS MULTI-DRAWER CABINETS	189	1	(LOT) (3) VISIO FLAT SCREEN TELEVISIONS (2) 27" AND (1) 50", with cart
160	1	(LOT) (2) SINGLE-DOOR CABINETS	190	1	65" VISIO FLAT SCREEN TELEVISION
161	1	(LOT) MISCELLANEOUS 2 AND 3-DRAWER CABINETS	190A	1	(LOT) (2) TELEVISIONS, (1) LG AND (1) PROSCAN, WITH CART
162	11	2-DRAWER LEGAL FILE CABINETS	190B	1	(LOT) (3) FORMICA TOP STEEL LEG TABLES
163	6	5-DRAWER CABINETS	191	1	(LOT) (6) MISCELLANEOUS COMPUTER TABLES
164	7	36" WIDE X 29" COMPUTER DESKS	192	1	(LOT) DISPLAY CASE, WALL DIVIDER, COAT RACK
165	1	(LOT) (2) 72" X 36" WOOD DESKS	193	1	(LOT) METAL SANDWICH BOARDS
			195	1	(LOT) (8) SKIDS CHRISTMAS TREES, DECORATIONS, LIGHTS, WREATHS
			196	1	(LOT) (3) SKIDS ARTWORK

Catalog for Auction:Direct Mail, Distribution Center

Lot Num	Qty.	Description	Lot Num	Qty.	Description
197	1	SKID PICTURE FRAMES (NEW)	226	3	3' PORTABLE LADDERS
198	1	(LOT) (3) SKIDS MMANNEQUINS	227	1	(LOT) 16"W ROLLER CONVEYOR
199	1	SKIDS FLOWER POTS	228	1	(LOT) POWIS MODEL FASTBACK 20
200	1	(LOT) QUEEN SIZE BED FRAME AND (2) END TABLES			STRIP/BINDING MACHINE WITH SUPPLIES AND SHELF
201	1	(LOT) FABRIC COUCH AND (2) CHAIRS	229	1	BAUM MODEL D3 THREE-SPINDLE PAPER DRILL; S/N 031PL0022 **Loading Fee Due the "ERRA" Hosea Project Movers \$140.00, SEE PRICING SPECIFICS**
202	1	DINING ROOM TABLE AND (4) CHAIRS			
203	1	(LOT) (2) END TABLES, TELEVISION STAND, COFFEE TABLE, 3-DRAWER DRESSER	230	1	SCHLEICHER MODEL 407 PAPER SHREDDER
204	1	(LOT) VASES, TABLES, GLASSWARE			
205	1	(LOT) LAMPS ON SKID	231	1	SIGNODE MODEL LBX2000 AUTOMATIC STRAPPER; S/N LBX2915, 32"W X 15"H CAP (2017) **Loading Fee Due the "ERRA" Hosea Project Movers \$75.00, SEE PRICING SPECIFICS**
206	1	PHOENIX MODEL 1212 ENGRAVER			
207	1	VISION CYLINDRICAL ENGRAVER WITH CONTROLLER	232	1	SIGNODE MODEL LB-2000 AUTOMATIC STRAPPER; S/N LB3000 26"W X 17"H CAP **Loading Fee Due the "ERRA" Hosea Project Movers \$75.00, SEE PRICING SPECIFICS**
208	1	HERMES MODEL B6 BEVELING MACHINE; S/N 912.437			
209	1	VIGOR MODEL EN-775 ENGRAVER	233	1	SIGNODE MODEL LB-2000 AUTOMATIC STRAPPER; S/N LB2999 26"W X 17"H CAP **Loading Fee Due the "ERRA" Hosea Project Movers \$75.00, SEE PRICING SPECIFICS**
210	1	(LOT) ENGRAVING PLATE MATERIAL, WITH CART			
211	1	MARTIN YALE MODEL 1501X0 AUTO FOLDER; S/N 11493	234	1	(LOT) SKID SIGNODE SP LB112C PLASTIC STRAPPING
212	1	SILHOUETTE SD DIGITAL CUTTING TOOL			
213	1	(LOT) PITNEY BOWES IE23 LABEL PRINTER AND TRIPLE WHEEL ASSEMBLY	235	1	BAUM MODEL 1320A-3-P-3 PILE FEED FOLDER WITH VACUUM PUMP; S/N 130JL0167 **Loading Fee Due the "ERRA" Hosea Project Movers \$500.00, SEE PRICING SPECIFICS**
213A	1	DJI PHANTOM 4 DRONE (DAMAGED)			
214	1	CANON XL2 3CCD DIGITAL VIDEO CAMCORDER	236	1	BAUM MODEL 1320A-3-P-3 PILE FEED FOLDER; S/N HC3-042 **Loading Fee Due the "ERRA" Hosea Project Movers \$500.00, SEE PRICING SPECIFICS**
215	1	(LOT) (5) SONY DCR HC62 HANDYCAMS AND (2) MICROPHONES			
216	1	(LOT) CAMERA TRI STANDS AND LIGHTS	237	1	BAUM MODEL 1320A-3-P-3 PILE FEED FOLDER; S/N HC2-033 **Loading Fee Due the "ERRA" Hosea Project Movers \$500.00, SEE PRICING SPECIFICS**
217	1	(LOT) GOPRO CAMERA CHEST HARNESSSES, WITH CART			
218	1	(LOT) DESK LAMPS	238	1	BAUM MODEL 1320C-3-8PG-3 FOLDER ATTACHMENT; S/N 131KA0006 **Loading Fee Due the "ERRA" Hosea Project Movers \$500.00, SEE PRICING SPECIFICS**
218A	1	BRONZE STATUE OF DAVID BY BERNINI			
219	1	3M MODEL LS950 LAMINATOR WITH SUPPLIES	239	1	23"W X 13" FOLDER CONVEYOR
220	1	(LOT) PITNEY BOWES SCALE, ACCU CUTTER PUNCH, ACCU CUTTER PORTABLE BENCH SHEAR			
221	9	STREAMFEEDER MODEL 1 ENVELOPE FEEDERS, WITH PARTS			
222	1	BOWE BELL & HOWELL MAIL VERIFIER PLUS			
223	1	CART WITH MISCELLANEOUS PLASTIC TOTES			
223A	1	(LOT) (2) ANTIQUE SHOP LIGHTS			
224	1	(LOT) ERGOTRON WORK-FIT SIT-STAND WORKSTATION AND SIT-STAND WORKSTATION			
225	1	(LOT) FATIGUE MATS WITH CART			

Catalog for Auction:Direct Mail, Distribution Center

Lot Num	Qty.	Description	Lot Num	Qty.	Description
241	1	KERN MODEL K3500 EIGHT-POCKET INSERTER; S/N 10000718, PLC CONTROL, (4) KERN ZSMS3500 TWO POCKET INSERTERS, KERN KL3500 OUTFEED CONVEYOR, LAKE IMAGE SYSTEMS CAMERA SYSTEM, REJECT & ENVELOPE TURNER, OUTFEED ACCUMULATION CONVEYOR **Loading Fee Due the "ERRA" Hosea Project Movers \$1,000.00, SEE PRICING SPECIFICS**	248	1	(LOT) MISCELLANEOUS INSERTER PARTS AND HARDWARE INCLUDING CABINETS, located back by machine shop
			249	11	MISCELLANEOUS MOTORS TO 1HP
			250	6	MISCELLANEOUS VACUUM PUMPS
			251	12	MISCELLANEOUS MOTORS TO 1/2 HP
			252	1	BECKER 90/4-130 VACUUM PUMP (NEW) ***BACK TO MAILING AREA***
			253	1	KIRK RUDY MODEL 519W INKJET ADDRESSING SYSTEM; S/N 1409103, WITH KIRK RUDY 496F ENVELOPE FEEDER, KIRK RUDY MODEL PX201 PHOENIX PRWT HEAD, KIRK RUDY QC100 CAMERA SYSTEM, DYER, PC (2014) **Loading Fee Due the "ERRA" Hosea Project Movers \$750.00, SEE PRICING SPECIFICS**
242	1	KERN MODEL K3500 EIGHT-POCKET INSERTER; S/N 10001392, PLC CONTROL, (4) KERN ZSMS3500 TWO POCKET INSERTERS, KERN KL3500 OUTFEED CONVEYOR, LAKE IMAGE SYSTEMS CAMERA SYSTEM, REJECT & ENVELOPE TURNER, OUTFEED ACCUMULATION CONVEYOR **Loading Fee Due the "ERRA" Hosea Project Movers \$1,000.00, SEE PRICING SPECIFICS**	254	1	KIRK RUDY MODEL 519W INKJET ADDRESSING SYSTEM; S/N 1409102, WITH KIRK RUDY 496F ENVELOPE FEEDER, KIRK RUDY MODEL PX201 PHOENIX PRWT HEAD, KIRK RUDY QC100 CAMERA SYSTEM, DYER, PC (2014) **Loading Fee Due the "ERRA" Hosea Project Movers \$750.00, SEE PRICING SPECIFICS**
243	1	KERN MODEL K3500 EIGHT-POCKET INSERTER; S/N 10001384, PLC CONTROL, (4) KERN ZSMS3500 TWO POCKET INSERTERS, KERN KL3500 OUTFEED CONVEYOR, LAKE IMAGE SYSTEMS CAMERA SYSTEM, REJECT & ENVELOPE TURNER, OUTFEED ACCUMULATION CONVEYOR **Loading Fee Due the "ERRA" Hosea Project Movers \$1,000.00, SEE PRICING SPECIFICS**	255	1	KIRK RUDY MODEL 540-H DUAL HEAD TABBER; S/N 16032271 & 16032269, WITH 496F ENVELOPE FEEDER, (2) COUNTER CONTROLS, OUTFEED BELT CONVEYOR (2016) **Loading Fee Due the "ERRA" Hosea Project Movers \$750.00, SEE PRICING SPECIFICS**
243A	1	(LOT) (1) SKID KERN INSERTER PARTS			
244	1	BELL & HOWELL MODEL A340-6 SIX-POCKET INSERTER WITH STREAM FEEDER; S/N 37-2910 **Loading Fee Due the "ERRA" Hosea Project Movers \$150.00, SEE PRICING SPECIFICS**	256	1	KIRK RUDY MODEL 540-H DUAL HEAD TABBER; S/N 16032270 & 16032272, WITH 496F ENVELOPE FEEDER, (2) COUNTER CONTROLS, OUTFEED BELT CONVEYOR (2016) **Loading Fee Due the "ERRA" Hosea Project Movers \$750.00, SEE PRICING SPECIFICS**
245	1	BELL & HOWELL MODEL A340-6 SIX-POCKET INSERTER WITH STREAM FEEDER; S/N 37-2908 **Loading Fee Due the "ERRA" Hosea Project Movers \$150.00, SEE PRICING SPECIFICS**			
246	1	17"W X 22"L SPEEDWAYS CONVEYOR BELT CONVEYOR **Loading Fee Due the "ERRA" Hosea Project Movers \$150.00, SEE PRICING SPECIFICS**	257	1	KIRK RUDY MODEL 221-223E DUAL HEAD TABBER; S/N 1002-876 AND 1002-877, WITH 215-36 ENVELOPE FEEDER, (2) COUNTER CONTROLS, BY BAUM FOLDERS **Loading Fee Due the "ERRA" Hosea Project Movers \$750.00, SEE PRICING SPECIFICS**
247	1	17"W X 50' SPEEDWAYS CONVEYOR BELT CONVEYOR **Loading Fee Due the "ERRA" Hosea Project Movers \$150.00, SEE PRICING SPECIFICS** ***GO TO MAINTENANCE ROOM IN MIDDLE OF PLANT***	258	1	60" IPM MODEL LPUTS30F ROTARY STRETCH WRAPPER WITH RAMP 5' DIAMETER ROTARY TABLE **Loading Fee Due the "ERRA" Hosea Project Movers \$250.00, SEE PRICING SPECIFICS**
			259	1	(LOT) STRETCH WRAP (1-SKID)

Catalog for Auction: Direct Mail, Distribution Center

Lot Num	Qty.	Description	Lot Num	Qty.	Description
260	1	(LOT) STEEL SHELVES	288	8	SECTIONS 54"W X 20'D X 12'6"H
261	1	(LOT) (50) STATE FLAGS, STANDS, POLES, PACKING CONTAINERS (ON (2) SKIDS)			ADJUSTABLE BEAM DRIVE-IN PALLET RACK, APPROX. (27) 40" X 148" UPRIGHTS
262	2	54" X 27" FLAT BED CARTS	289	27	SECTIONS 54"W X 20'D X 12'6"H
262A	3	FLAT BED CARTS			ADJUSTABLE BEAM DRIVE-IN PALLET RACK, APPROX. (84) 40" X 148" UPRIGHTS
263	15	2-SHELF CARTS	290	27	SECTIONS 54"W X 20'D X 12'6"H
263A	13	2-SHELF CARTS			ADJUSTABLE BEAM DRIVE-IN PALLET RACK
264	1	(LOT) FIRST AID AND CPR SUPPLIES AND MANNEQUIN	290A	6	SECTIONS 28" X 10' X 8' HIGH ADJUSTABLE BEAM PALLET RACK
264A	1	(LOT) (1) SKID MISCELLANEOUS TOOLS AND SUPPLIES	290B	1	(LOT) (2) WHEELCHAIRS, (1) ELECTRIC AND (1) MANUAL ***GO TO BASEMENT***
265	1	(LOT) (3) SKIDS WITH BLEACH AND MISCELLANEOUS JANITORIAL SUPPLIES	291	1	(LOT) FLEX AND DUCT, AIR FILTERS, DUCT, MOTORS, SHELVING, BENCH **LOCATED IN BASEMENT**
266	1	BOSCH OR-T 250 CORDLESS STRAPPER WITH CHARGERS	292	1	****40 HP INGERSOLL RAND MODEL SSR-EP40 CABINET TYPE AIR COMPRESSOR; S/N J0998U87C, 17,748 HOURS****Sold subject to bid confirmation, Owner will have 48 hours to accept or reject the high bid**** **LOCATED IN BASEMENT** **Loading Fee Due the "ERRA" Hosea Project Movers \$1,800.00, SEE PRICING SPECIFICS**
267	1	(LOT) (2) ORGAPACK OR-T 85X CORDLESS STRAPPERS WITH CHARGER			
268	1	(LOT) STRAPPING WITH (6) SHELF STEEL CART			
269	1	HAND STRAPPING SET			
270	1	19" IDEAL MODEL 5009-Z PAPER SHREDDER; S/N 2720598 (2006) **Loading Fee Due the "ERRA" Hosea Project Movers \$250.00, SEE PRICING SPECIFICS**			
271	1	18 CU. FT. STEEL DUMPING CART	293	1	(LOT) MISCELLANEOUS TOOLS INCLUDING PIPE WRENCHES, PIPE BENDERS, THREADER PIPE CUTTERS **LOCATED IN BASEMENT**
272	1	18 CU. FT. STEEL DUMPING CART			
273	1	18 CU. FT. STEEL DUMPING CART			
274	1	18 CU. FT. STEEL DUMPING CART			
275	1	18 CU. FT. STEEL DUMPING CART	294	1	(LOT) CONTENTS OF MAINTENANCE INCLUDING ELECTRICAL HARDWARE, PLUGS, BATTERIES, LIGHTING, PLUMBING, WIRE **LOCATED IN BASEMENT**
276	1	18 CU. FT. STEEL DUMPING CART			
277	1	18 CU. FT. STEEL DUMPING CART			
278	1	18 CU. FT. STEEL DUMPING CART			
279	1	18 CU. FT. STEEL DUMPING CART	295	1	(LOT) (5) MISCELLANEOUS MOTOTRS TO 25 HP **LOCATED IN BASEMENT**
280	1	18 CU. FT. STEEL DUMPING CART			
280A	1	18 CU. FT. STEEL DUMPING CART	296	1	3 TON RAMCO SHOPHAND 5000 ENGINE LIFT **LOCATED IN BASEMENT**
280B	1	18 CU. FT. STEEL DUMPING CART			
280C	1	18 CU. FT. STEEL DUMPING CART	297	1	6" X 18" RAMCO MODEL RS-90 HORIZONTAL BAND SAW **LOCATED IN BASEMENT** **Loading Fee Due the "ERRA" Hosea Project Movers \$150.00, SEE PRICING SPECIFICS**
281	1	1-CU. YD. RUBBERMAID DUMPING CART			
281A	1	1-CU. YD. RUBBERMAID DUMPING CART			
282	1	1-CU. YD. RUBBERMAID DUMPING CART			
282A	1	1-CU. YD. RUBBERMAID DUMPING CART	298	1	120"L X 12" ALM X 72"H 2-SIDED CANTELEVER RACK WITH CONTENTS PIPE, ELECTRICAL **LOCATED IN BASEMENT** **Loading Fee Due the "ERRA" Hosea Project Movers \$150.00, SEE PRICING SPECIFICS**
283	1	1-CU. YD. RUBBERMAID DUMPING CART			
283A	1	1-CU. YD. RUBBERMAID DUMPING CART			
284	1	1-CU. YD. RUBBERMAID DUMPING CART			
285	1	1-CU. YD. RUBBERMAID DUMPING CART			
286	1	1-CU. YD. RUBBERMAID DUMPING CART	299	1	(LOT) 10-DRAWER HARDWARE CABINET WITH CONTENTS, BENCH, (2) CARTS, (2) VACS, (2) VALVES **LOCATED IN BASEMENT**
287	9	SECTIONS 54"W X 20'D X 12'6"H ADJUSTABLE BEAM DRIVE-IN PALLET RACK, APPROX. (30) 40" X 148" UPRIGHTS			

Catalog for Auction:Direct Mail, Distribution Center

Lot Num	Qty.	Description	Lot Num	Qty.	Description
300	1	800 LB TOLEDO MODEL 31-1821-FD PORTABLE PLATFORM SCALE; S/N 10521 **LOCATED IN BASEMENT** **Loading Fee Due the "ERRA" Hosea Project Movers \$75.00, SEE PRICING SPECIFICS**	304	1	****114 TON CARRIER MODEL 30HXA116RY-640 HIGH EFFICIENCY INDOOR LIQUID SCREW CHILLER; S/N 3099F37779 ****Sold subject to bid confirmation, Owner will have 48 hours to accept or reject the high bid**** **LOCATED IN BASEMENT** **Loading Fee Due the "ERRA" Hosea Project Movers \$2,000.00, SEE PRICING SPECIFICS** ***BUYER IS RESPONSIBLE FOR PUMPING REFRIGERANT - BUYER MUST HAVE UNITS DISCONNECTED BY LICENSED ELECTRICIAN***
301	1	****114 TON CARRIER MODEL 30HXA116RY-640 HIGH EFFICIENCY INDOOR LIQUID SCREW CHILLER; S/N 440383225 ****Sold subject to bid confirmation, Owner will have 48 hours to accept or reject the high bid**** **LOCATED IN BASEMENT** **Loading Fee Due the "ERRA" Hosea Project Movers \$2,000.00, SEE PRICING SPECIFICS** ***BUYER IS RESPONSIBLE FOR PUMPING REFRIGERANT - BUYER MUST HAVE UNITS DISCONNECTED BY LICENSED ELECTRICIAN***	305	1	****UNKNOWN TON CARRIER MODEL 30H5120-F500 HIGH EFFICIENCY INDOOR LIQUID SCREW CHILLER; S/N 0894J07160 ****Sold subject to bid confirmation, Owner will have 48 hours to accept or reject the high bid**** **LOCATED IN BASEMENT** **Loading Fee Due the "ERRA" Hosea Project Movers \$2,000.00, SEE PRICING SPECIFICS** ***BUYER IS RESPONSIBLE FOR PUMPING REFRIGERANT - BUYER MUST HAVE UNITS DISCONNECTED BY LICENSED ELECTRICIAN***
302	1	****114 TON CARRIER MODEL 30HXA116RY-640 HIGH EFFICIENCY INDOOR LIQUID SCREW CHILLER; S/N 5100F52750 ****Sold subject to bid confirmation, Owner will have 48 hours to accept or reject the high bid**** **LOCATED IN BASEMENT** **Loading Fee Due the "ERRA" Hosea Project Movers \$2,000.00 FOR CHILLER ONLY NOT CONDENSORS ON ROOF, SEE PRICING SPECIFICS** ***BUYER IS RESPONSIBLE FOR PUMPING REFRIGERANT - BUYER MUST HAVE UNITS DISCONNECTED BY LICENSED ELECTRICIAN*** 7	306	1	(LOT) MISCELLANEOUS CABINETS (NO BLUEPRINT CABINET) located in basement
303	1	****114 TON CARRIER MODEL 30HXA116RY-640 HIGH EFFICIENCY INDOOR LIQUID SCREW CHILLER; S/N 2698F53620 ****Sold subject to bid confirmation, Owner will have 48 hours to accept or reject the high bid**** **LOCATED IN BASEMENT** **Loading Fee Due the "ERRA" Hosea Project Movers \$2,000.00, SEE PRICING SPECIFICS** ***BUYER IS RESPONSIBLE FOR PUMPING REFRIGERANT - BUYER MUST HAVE UNITS DISCONNECTED BY LICENSED ELECTRICIAN***	307	1	CART WITH VISE AND DOUBLE END GRINDER, located in basement
			308	1	PORTABLE AIR COMPRESSOR
			309	1	(LOT) GEAR PULLERS WITH CART, located in basement
			310	1	(LOT) TUB WITH MISCELLANEOUS SCRAP, located in basement
			311	1	(LOT) (2) MULTI-SHELF CARTS WITH FRIDGE
			312	1	(LOT) (2) 3' X 4' PORTABLE WOOD TABLES ***OUTSIDE MAINTENANCE BUILDING***
			313	1	JOHN DEERE 855 DIESEL TRACTOR WITH HYDRAULIC LOADER BUCKET: S/N LV0855E201863 PTO, YAMMAR DIESEL ENGINE, 60" HYDRO CUT MOWER, 1,250 HOURS, located in rear maintenance building
			314	1	72" JOHN DEERE 997 Z-TRAK ZERO-TURN DIESEL MOWER, YANMAR ENGINE, 1,182 HOURS, located in rear maintenance building
			315	1	JOHN DEERE X300 GAS POWERED TRACTOR, KAWASAKI ENGINE, 42" MOWER, BAGGER, 634 HOURS, located in rear maintenance building

Catalog for Auction: Direct Mail, Distribution Center

Lot Num	Qty.	Description	Lot Num	Qty.	Description
316	1	54" JOHN DEERE HYDRAULIC SNOW PLOW BLADE, located in rear maintenance building	336	1	5 HP SPEEDAIRE HORIZONTAL TANK AIR COMPRESSOR **Loading Fee Due the "ERRA" Hosea Project Movers \$100.00, SEE PRICING SPECIFICS**, located in rear maintenance building
317	1	DELETE			
318	1	62" JOHN DEERE BLOWER / BAGGER, located in rear maintenance building			
319	1	6 HP BILLY GOAT VS50 GAS POWERED WALK BEHIND LEAF VAC, located in rear maintenance building	336A	1	(LOT) CABINETS WITH HARDWARE, MACHINE PARTS, located in rear maintenance building
320	1	(LOT) JACKSON NO. 45 MIXING BOX, CRAMER MOORE CHALK MARKER, BRIGGS AND STRATTON EDGER, located in rear maintenance building	337	2	HARDWARE CABINETS WITH CONTENTS, located in rear maintenance building
			338	1	(LOT) (3) FILE CABINETS, (1) CART WITH MISCELLANEOUS HARDWARE, PARTS, located in rear maintenance building
321	1	55 GAL. CAP JUSTRITE FLAMMABLE STORAGE CABINET **Loading Fee Due the "ERRA" Hosea Project Movers \$50.00, SEE PRICING SPECIFICS**, located in rear maintenance building			***GO TO MAIN AUCTION ENTRANCE***
			341	1	DESK CUBICLE WITH CHAIR
			342	4	WERNER FIBERGLASS LADDERS (1) 10', (2) 8', (1) 6'
322	1	30 GAL. CAP SE-CURALL FLAMMABLE STORAGE CABINET **Loading Fee Due the "ERRA" Hosea Project Movers \$50.00, SEE PRICING SPECIFICS**, located in rear maintenance building	366	1	LOTS 366-399 OPEN
					SOUTH HALLWAY OFFICE AREA
			400	1	52"W TURBO AIR MODEL M3R47-2 PORTABLE 2-DOOR REFRIGERATOR
					Loading Fee Due the "ERRA" Hosea Project Movers \$100.00, SEE PRICING SPECIFICS
323	1	30 GAL. CAP SE-CUR-ALL FLAMMABLE STORAGE CABINET **Loading Fee Due the "ERRA" Hosea Project Movers \$50.00, SEE PRICING SPECIFICS**, located in rear maintenance building	401	1	(LOT) SCOTSMAN PRODIGY PLUS ICE MAKER AND SERVED ICE DISPENSER
					Loading Fee Due the "ERRA" Hosea Project Movers \$100.00, SEE PRICING SPECIFICS
324	1	30 GAL. CAP SE-CUR-ALL FLAMMABLE STORAGE CABINET **Loading Fee Due the "ERRA" Hosea Project Movers \$50.00, SEE PRICING SPECIFICS**, located in rear maintenance building	401A	1	2' X 4' CONDIMENT STATION W/ NAPKIN DISPENSERS, CUP DISPENSER AND TOASTER
			401B	1	(LOT) (2) CHAIRS, 1-LEATHER, 1-CLOTH AND MINI FRIDGE
					OFFICE AREA PAST TRUE REFRIGERATOR ON RIGHT
325	1	30 GAL. CAP SE-CUR-ALL FLAMMABLE STORAGE CABINET **Loading Fee Due the "ERRA" Hosea Project Movers \$50.00, SEE PRICING SPECIFICS**, located in rear maintenance building	402	1	(LOT) (1) 3-STATION, (1) 2-STATION, AND (1) CONFERENCE ROOM MODULAR OFFICE WITH (1) CHAIR PER STATION, NO CHAIR FOR CONFERENCE TABLE
					PROCEED UP HALLWAY TOWARD FRONT OF BUILDING TO MUSEUM AREA ON LEFT
326	1	(LOT) (2) LADDERS; (1) 25' ALUMINUM EXTENSION LADDER AND (1) 6' FIBERGLASS LADDER, located in rear maintenance building	403	1	8'L X 21'L X 2'D X 8'H L-SHAPED LIGHTED PLEXIGLASS DISPLAY CASE **Loading Fee Due the "ERRA" Hosea Project Movers \$400.00, SEE PRICING SPECIFICS**
329	1	(LOT) POWER TOOLS INCLUDING DRILLS AND ROUTERS, located in rear maintenance building			
330	2	BOSCH ROTARY HAMMERS, located in rear maintenance building	404	1	116"L X 24"D X 96"H LIGHTED PLEXIGLASS DISPLAY CASE **Loading Fee Due the "ERRA" Hosea Project Movers \$150.00, SEE PRICING SPECIFICS**
331	1	PORTER CABLE CIRCULAR SAW, located in rear maintenance building			
332	1	GREENLEE MODEL 7306 KNOCKOUT DRIVER SET, located in rear maintenance building	405	4	54"L X 44"H GLASS PARTITIONS

Catalog for Auction: Direct Mail, Distribution Center

Lot Num	Qty.	Description	Lot Num	Qty.	Description
405A	1	72" WIDE X 80" DECORATIVE DOOR SET	428	1	(LOT) EXECUTIVE OFFICE WITH U-SHAPED
406	1	(LOT) CISCO IT SWITCHES			DESK, (2) 2-DRAWER CABINETS,
407	1	(LOT) HP HARD DRIVES TO 750GB, SWITCHES, AND RECHARGABLE BATTERIES	429	1	BOOKSHELF, COFFEE TABLE, 3 CHAIRS
408	1	(LOT) (4) HP COMPUTERS, (3) MONITORS, (1) WOOFER	430	1	(LOT) EXECUTIVE OFFICE WITH L-SHAPED DESK, (2) CREDENZAS, COFFEE TABLE, (2) CHAIRS
409	1	SIT DOWN/STANDING COMPUTER WORK STATION WITH (2) MONITOR STANDS			1 (LOT) EXECUTIVE OFFICE WITH U-SHAPED DESK, (2) 2-DRAWER CABINETS, COFFEE TABLE, (3) CHAIRS **Loading Fee Due the "ERRA" Hosea Project Movers \$175.00, SEE PRICING SPECIFICS**
410	2	4-DRAWER LATERAL CABINETS ***CONTINUE TOWARD SIDE OF BUILDING***	431	1	(LOT) U-SHAPED EXECUTIVE DESK WITH FILE CABINET AND CHAIR
411	1	(LOT) CONTENTS OF OFFICE U-SHAPED WOOD DESK, 2-DRAWER FILE CABINET, CHAIR	432	1	(LOT) EXECUTIVE OFFICE WITH U-SHAPED DESK, 3' DIAMETER TABLE (2) 2-DRAWER CABINETS, CHAIR
412	7	PERSON 80" X 84" MODULAR OFFICE CUBICLES WITH CHAIRS (NO STANDUP COMPUTER WORK STATIONS)	433	1	(LOT) EXECUTIVE OFFICE WITH U-SHAPED DESK, 3' DIAMETER TABLE, 2-DRAWER CABINET, (4) CHAIRS
413	5	PERSON 80" X 84" MODULAR OFFICE CUBICLES WITH CHAIRS (NO STAND UP COMPUTER WORK STATIONS)	434	1	(LOT) EXECUTIVE OFFICE WITH U-SHAPED DESK, 3' DIAMETER TABLE, 2-DRAWER CABINET, (3) CHAIRS
414	3	PERSON 90" X 90" MODULAR OFFICES CUBICLES WITH CHAIRS (NO STAND UP COMPUTER WORK STATIONS)	435	1	(LOT) EXECUTIVE OFFICE WITH U-SHAPED DESK, 2-DRAWER CABINET, (5) CHAIRS
415	3	PERSON 90" X 90" MODULAR OFFICE CUBICLES WITH CHAIRS (NO STAND UP COMPUTER WORK STATIONS)	436	2	PERSON 96" X 92" MODULAR OFFICE CUBICLES WITH (2) CHAIRS
417	7	HON FILE CABINETS, VARIOUS SIZES	437	6	PERSON 92" X 94" MODULAR OFFICE CUBICLES WITH (6) CHAIRS
418	1	(LOT) DISASSEMBLED MODULAR OFFICE	438	3	4-DRAWER CABINETS
419	1	(LOT) 8' CONFERENCE TABLE WITH CREDENZA, TABLE, (9) CHAIRS	439	2	STEEL CREDENZAS
420	1	(LOT) 6' CABINET, (1) SMALL MAGIC CHEF REFRIGERATORS, MICROWAVE OVEN	440	4	PERSON 94" X 94" MODULAR OFFICE CUBICLES WITH (4) CHAIRS
421	7	OFFICE CHAIRS	441	5	PERSON 94" X 94" MODULAR OFFICE CUBICLES WITH (4) CHAIRS
422	1	NEC MODEL 4M330W HDMI OVERHEAD PROJECTOR ***CONTINUE TOWARD SIDE OF BUILDING, FURTHEST ROOM OF OFFICES IN EAST SIDE OF BUILDING***	442	8	PERSON 100" X 76" MODULAR OFFICE CUBICLES WITH (8) CHAIRS
423	1	(LOT) U-SHAPED EXECUTIVE DESK WITH (3) CHAIRS	443	6	PERSON 100" X 76" MODULAR OFFICE CUBICLES WITH (6) CHAIRS
424	1	(LOT) 128" X 66" U-SHAPED MODULAR DESK WITH 2-DRAWER CABINET, L-SHAPED TABLE, CHAIR	444	4	PERSON 100" X 76" MODULAR OFFICE CUBICLES WITH (4) CHAIRS
425	5	PERSON 110" X 72" MODULAR OFFICE CUBICLES WITH OVERHEAD CABINETS AND CHAIRS	445	1	(LOT) EXECUTIVE OFFICE WITH U-SHAPED DESK, 2-DOOR/2-DRAWER CABINET, (4) DRAWER CABINET
426	2	CABINETS, 6-DRAWER AND 9-DRAWER	446	1	(LOT) EXECUTIVE OFFICE WITH U-SHAPED DESK, (2) CHAIRS
427	1	(LOT) EXECUTIVE OFFICE WITH U-SHAPED DESK, 3' DIAMETER TABLE, (4) CHAIRS	447	1	EXECUTIVE HUTCH
			448	1	5' PORTABLE TABLE

Catalog for Auction:Direct Mail, Distribution Center

Lot Num	Qty.	Description	Lot Num	Qty.	Description
449	1	(LOT) CONTENTS OF CONFERENCE ROOM INCLUDING 14' CONFERENCE TABLE, (11) ROLLER AND (5) ARM CHAIRS, 2-DOOR CABINET, (4) SHELVES, (4) WIRELESS SPEAKERS	469	2	PERSON 94" X 72" MODULAR OFFICE CUBICLES WITH CHAIRS
		GO TO IT AREA	470	2	PERSON 94" X 72" MODULAR OFFICE CUBICLES WITH CHAIRS
450	2	PERSON 94" X 90" MODULAR OFFICE CUBICLES WITH (2) CHAIRS, 4-DRAWER CABINET	471	1	30" X 30" TABLE WITH (3) CHAIRS
451	2	PERSON 92" X 86" MODULAR OFFICE CUBICLES WITH (2) CHAIRS	472	1	(LOT) EXECUTIVE U-SHAPE DESK WITH (3) CHAIRS
452	4	PERSON 84" X 86" MODULAR OFFICE CUBICLES WITH (4) CHAIRS	473	1	(LOT) EXECUTIVE OFFICE WITH U-SHAPED DESK, 2-DOOR/2-DRAWER CABINET, (3) CHAIRS, END TABLE
453	3	72" X 56" L-SHAPED DESKS WITH (3) 2-DRAWER CABINETS	474	1	2-DOOR CABINET
454	1	(LOT) CONTENTS OF OFFICE L-SHAPED DESK, 3' DIAMETER TABLE, 2-DRAWER CABINET	475	1	DELETE
455	1	80" X 98" INDIVIDUAL MODULAR OFFICE WITH U-SHAPED DESK AND CHAIR	476	1	74" X 84" L-SHAPE RECEPTION DESK
456	2	TABLES	476A	1	CRYSTAL CHANDELIER
		GO TOWARD FRONT OF BUILDING IN EAST CORNER	476B	1	CRYSTAL CHANDELIER
457	4	PERSON 11' X 9' MODULAR OFFICES WITH (9) ARM AND ROLLER CHAIRS	477	1	(LOT) (6) LEATHER CHAIRS AND COFFEE TABLE
458	1	(LOT) EXECUTIVE OFFICE WITH DESK, CREDENZA, 2-DRAWER CABINET, END TABLE, 94) CHAIRS	478	1	46" NEC MODEL MULTI-SYNC V462-TM TELEVISION
459	1	(LOT) EXECUTIVE OFFICE WITH U-SHAPED DESK, 2-DRAWER CABINET, (2) CHAIRS	479	1	46" NEC MODEL MULTI-SYNC V462-TM TELEVISION
460	2	L-SHAPED DESKS WITH (1) CHAIR	480	1	(LOT) BOGEN MODEL GS5000 AMPLIFIER AND SPECO TECH MODEL MHL-5S MICROPHONE
461	1	(LOT) U-SHAPED DESK WITH (2) CHAIRS	481	1	(LOT) (4) LEATHER CHAIRS AND (2) END TABLES
462	1	172" X 78" MODULAR OFFICE WITH (2) CHAIRS	482	1	(LOT) 103" X 103" RECEPTION DESK WITH CREDENZA
463	1	14-COMPARTMENT REMCO VERTICAL CAROUSEL, 102" WIDE X 60" DEEP X 96" HIGH DIMENSIONS	483	5	STEELCASE 2-DRAWER FILE CABINETS
464	1	14-COMPARTMENT REMCO VERTICAL CAROUSEL, 102" WIDE X 60" DEEP X 96" HIGH DIMENSIONS	484	1	(LOT) EXECUTIVE OFFICE INCLUDING DESK, (2) CREDENZAS, (3) LEATHER CHAIRS, BOOK SHELF
465	1	(LOT) (7) CHAIRS AND 24" DIAMETER TABLE	485	1	(LOT) EXECUTIVE OFFICE INCLUDING U-SHAPE DESK, BOOKSHELF, (3) LEATHER CHAIRS, END TABLE BOOKSHELF, (2) SMALL TABLES
		HEAD DOWN HALLWAY TOWARD RECEPTION AREA	486	1	(LOT) EXECUTIVE OFFICE INCLUDING U-SHAPED DESK, CREDENZA, 2-DOOR CABINET, (4) LEATHER CHAIRS
466	3	PERSON 94" X 72" MODULAR OFFICE CUBICLES WITH CHAIRS	487	1	37" MAGNAVOX TB WITH BUILT-IN DVD PLAYER
467	3	PERSON 94" X 72" MODULAR OFFICE CUBICLES WITH CHAIRS	488	1	(LOT) EXECUTIVE OFFICE INCLUDING DESK, CREDENZA, (2) TABLES, (5) LEATHER CHAIRS, (2) LAMPS
468	3	PERSON 94" X 72" MODULAR OFFICE CUBICLES WITH CHAIRS	489	1	37" MAGNAVOX TV WITH BUILT-IN DVD PLAYER

Catalog for Auction: Direct Mail, Distribution Center

Lot Num	Qty.	Description	Lot Num	Qty.	Description
490	1	(LOT) EXECUTIVE OFFICE INCLUDING U-SHAPE DESK, 4-DRAWER CABINET, AND (2) LEATHER CHAIRS	509	1	(LOT) CONTENTS OF OFFICE INCLUDES U-SHAPED DESK WITH (2) 2-DRAWER CABINETS AND (3) CHAIRS
491	1	(LOT) (2) 103" X 76" L-SHAPE DESKS AND 3-DRAWER CABINET, (2) CHAIRS	510	1	3-DOOR/3-DRAWER CABINET ***CONTINUE DOWN HALLWAY TO NORTHWEST CORNER OF BUILDING TO OFFICES ON LEFT***
492	1	(LOT) EXECUTIVE OFFICE INCLUDING U-SHAPED DESK, 2-DRAWER CABINET, 6' TABLE WITH (4) CHAIRS, LEATHER CHAIR, END TABLE	511	2	PERSON 192" X 96" MODULAR OFFICE CUBICLES WITH (3) 2-DRAWER CABINETS, (2) 3-DRAWER CABINETS, (6) CHAIRS
493	1	(LOT) EXECUTIVE OFFICE WITH U-SHAPED DESK, (2) LEATHER CHAIRS, END TABLE	512	1	(LOT) (12) 3-DRAWER, (2) 4-DRAWER FILE CABINETS
494	1	(LOT) EXECUTIVE OFFICE WITH U-SHAPED DESK, BOOKSHELF, 6' TABLE WITH (4) CHAIRS, (4) LEATHER CHAIRS, (2) END TABLES	513	1	5-DOOR CABINET
			514	4	4-DOOR CABINETS
			515	1	(LOT) 51" DIAMETER TABLE WITH (5) CHAIRS
495	1	168" CONFERENCE TABLE WITH (2) CREDENZAS	516	1	SECTION 120" X 96" MODULAR OFFICE CUBICLES WITH (2) CHAIRS, 2-DRAWER CABINET, (5) 3-DRAWER CABINETS
496	1	7' CONFERENCE TABLE			
497	9	LEATHER CHAIRS			
498	9	LEATHER CHAIRS	517	1	(LOT) EXECUTIVE OFFICE WITH U-SHAPED DESK, 36" DIAMETER TABLE, (6) CHAIRS ***HEAD DOWN HALLWAY BACK TOWARD PLANT***
499	9	LEATHER CHAIRS			
500	1	80" SHARP AQUOS LED TOUCHSCREEN SMART TELEVISION SYSTEM WITH BOGEN ORATOR INFRARED VOICE REINFORCEMENT SYSTEM, SONY BLU-RAY PLAYER ***PROCEED DOWN HALLWAY TOWARD WEST SIDE OF BUILDING***	518	1	(LOT) 5' PORTABLE TABLE AND 4-SIDED BOOKSHELF
			519	1	(LOT) 84" X 70" L-SHAPE RECEPTION DESK WITH (2) 5' BENCHES AND 2-DRAWER CABINET
501	5	PERSON 96" X 72" MODULAR OFFICE CUBICLES WITH (5) CHAIRS	520	1	(LOT) 64" X 64" DESK WITH (2) CHAIRS
502	3	PERSON 96" X 72" MODULAR OFFICE CUBICLES WITH (5) CHAIRS	521	4	PERSON 72" X 96" MODULAR OFFICE CUBICLES WITH (4) CHAIRS
503	3	PERSON 96" X 72" MODULAR OFFICE CUBICLES WITH (5) CHAIRS	522	4	PERSON 72" X 96" MODULAR OFFICE CUBICLES WITH (4) CHAIRS
504	1	(LOT) CONTENTS OF OFFICE INCLUDES U-SHAPED DESK WITH 2-DRAWER CABINET AND (3) CHAIRS	523	3	5' TABLES
			524	1	(LOT) CONTENTS OF OFFICE WITH U-SHAPED DESK, 2-DOOR CABINET, (3) CHAIRS
505	1	(LOT) CONTENTS OF OFFICE INCLUDES U-SHAPED DESK WITH (2) 2-DRAWER CABINETS AND (3) CHAIRS	525	1	(LOT) CONTENTS OF OFFICE WITH U-SHAPED DESK, 4-DOOR CABINET, 36" X 36" TABLE WITH (4) CHAIRS, (1) OFFICE CHAIR
506	1	(LOT) CONTENTS OF OFFICE INCLUDES U-SHAPED DESK WITH (2) 2-DRAWER CABINETS AND (3) CHAIRS	526	1	(LOT) CONTENTS OF OFFICE WITH DESK, 4-DOOR CABINET, CHAIR ***CONTINUE DOWN HALLWAY TOWARD PLANT, OFFICE ON LEFT***
507	1	(LOT) CONTENTS OF OFFICE INCLUDES U-SHAPED DESK WITH (2) 2-DRAWER CABINETS AND (3) CHAIRS	527	1	(LOT) RECEPTION DESK AND (3) CHAIRS
508	1	(LOT) CONTENTS OF OFFICE INCLUDES U-SHAPED DESK WITH (2) 2-DRAWER CABINETS AND (3) CHAIRS	528	1	(LOT) CONTENTS OF OFFICE INCLUDING U-SHAPED DESK, TABLE, (2) CHAIRS
			529	1	(LOT) CABINET, REFRIGERATOR, KEURIG

Catalog for Auction:Direct Mail, Distribution Center

Lot Num	Qty.	Description	Lot Num	Qty.	Description
		CONTINUE DOWN HALLWAY TOWARD PLANT, OFFICE ON LEFT			
530	1	(LOT) (9) 48" TABLES, 6' FOLDING TABLE, BOOKSHELF, (10) CHAIRS, CHALK/DRY BOARD, PROJECTOR SCREEN	546	1	14-STATION KARDEX LEKTRIEVER SERIES 80 VERTICAL CAROUSEL **Loading Fee Due the "ERRA" Hosea Project Movers \$400.00, SEE PRICING SPECIFICS**
		ACROSS HALLWAY			***AROUND THE CORNER TO OFFICE ON RIGHT***
531	1	(LOT) (6) 70" X 64" L-SHAPED DESKS, (2) COMPUTER HUTCHES, (2) 48" SIDE TABLES, 70" TABLE	547	1	(LOT) CONTENTS OF OFFICE INCLUDING (2) U-SHAPED DESKS
532	1	(LOT) U-SHAPED DESK, 70" TABLE, BOOKSHELF	548	2	PERSON 92" X 92" MODULAR OFFICES WITH (2) CHAIRS
533	1	(LOT) CONTENTS OF OFFICE (2) 20" X 64" L-SHAPED DESKS, (3) 5' TABLES, AND (3) CHAIRS	549	2	PERSON 112" X 86" MODULAR OFFICES WITH (2) CHAIRS
534	1	24" X 27" X 61" MEILINK PORTABLE COMBINATION SAFE	550	1	(LOT) CREDENZA, 3-DRAWER CABINET, 2-DOOR CABINET WITH OFFICE SUPPLIES
535	1	(LOT) DESK, (2) 90" BENCHES, 2-DRAWER CABINET, 3-DRAWER CABINET, (2) BENCHES	551	1	42" HP DESIGNJET Z3200PS PHOTO COLOR PRINTER WITH PAPER SUPPLIES **Loading Fee Due the "ERRA" Hosea Project Movers \$100.00, SEE PRICING SPECIFICS**
536	1	SWINGLINE MODEL 6413 COMMERCIAL SHREDDER	552	1	(LOT) CONTENTS OF OFFICE INCLUDING L-SHAPED DESK, 2-DRAWER CABINET, BOOKSHELF, (3) CHAIRS
537	5	OFFICE CHAIRS	553	1	(LOT) CONTENTS OF OFFICE INCLUDING L-SHAPED DESK, DESK, CREDENZA, BOOKSHELF, (3) CHAIRS
		CONTINUE DOWN HALLWAY TOWARD PLANT, OFFICE OF LEFT			
538	2	PERSON 108" X 68" MODULAR DESKS	554	1	(LOT) CONTENTS OF OFFICE INCLUDING U-SHAPED DESK, 5-DRAWER CABINET, (3) CHAIRS
539	1	(LOT) MAIL SORTING STATION INCLUDING (2) CARTS, 22-STATION PIGEON HOLE BENCH, 4' TABLE	555	1	(LOT) CONTENTS OF OFFICE INCLUDING U-SHAPED DESK, BOOKSHELF, END TABLE, (3) CHAIRS
540	1	(LOT) OFFICE SUPPLIES WITH 2-DOOR CABINET AND 5' PORTABLE TABLE	556	1	(LOT) CONTENTS OF OFFICE INCLUDING L-SHAPED DESK, (2) CREDENZAS, BOOKSHELF, END TABLE, (3) CHAIRS
541	1	14-STATION KARDEX LEKTRIEVER SERIES 80 VERTICAL CAROUSEL **Loading Fee Due the "ERRA" Hosea Project Movers \$400.00, SEE PRICING SPECIFICS**	557	1	(LOT) 10' CONFERENCE TABLE, 2-DOOR CABINET, 4-DOOR CABINET, BOOKSHELF, (8) CHAIRS
542	1	14-STATION KARDEX LEKTRIEVER SERIES 80 VERTICAL CAROUSEL **Loading Fee Due the "ERRA" Hosea Project Movers \$400.00, SEE PRICING SPECIFICS**	558	1	(LOT) SANYO PRO PLC-XT21 OVERHEAD PROJECTOR, JVC DVD PLAYER, CROWN XLS202 AUDIO-VISUAL PROCESSOR, EXTRON XPS SWITCH, EXTRON ADV100 TV RETURN, CRESTON STX-1700C CONTROLLER, (2) EV SPEAKERS, MOTORIZED SCREEN (NO CHASING WIRE)
543	1	14-STATION KARDEX LEKTRIEVER SERIES 80 VERTICAL CAROUSEL **Loading Fee Due the "ERRA" Hosea Project Movers \$400.00, SEE PRICING SPECIFICS**			***TAKE HALLWAY TOWARD CENTER OF BUILDING TO OFFICE ON RIGHT***
544	1	14-STATION KARDEX LEKTRIEVER SERIES 80 VERTICAL CAROUSEL **Loading Fee Due the "ERRA" Hosea Project Movers \$400.00, SEE PRICING SPECIFICS**	559	1	(LOT) CONTENTS OF OFFICE INCLUDING (2) U-SHAPED DESKS, DESK, COMPUTER HUTCH, (3) CABINETS, (4) CHAIRS
545	1	14-STATION KARDEX LEKTRIEVER SERIES 80 VERTICAL CAROUSEL **Loading Fee Due the "ERRA" Hosea Project Movers \$400.00, SEE PRICING SPECIFICS**			

Catalog for Auction:Direct Mail, Distribution Center

Lot Num	Qty.	Description	Lot Num	Qty.	Description
		CONTINUE TOWARD PLANT TO OFFICE ON RIGHT	589	4	MAGIC CHEF AND DAUBY MINI REFRIGERATORS
560	2	PERSON 100" X 72" MODULAR OFFICES WITH (2) CHAIRS	590	3	KENMORE AND HAIER MINI REFRIGERATORS
561	4	PERSON 100" X 72" MODULAR OFFICES WITH (4) CHAIRS	591	2	VACUUMS
562	1	(LOT) 72" HUTCH AND END TABLE	592	1	80" SHARP AQUOS LED TOUCHSCREEN SMART TELEVISION SYSTEM WITH CAMERA, STARLEAF 2020 TOUCH TELEPRESENCE, REVOLABS MICROPHONES
563	1	(LOT) CONTENTS OF OFFICE INCLUDING U-SHAPED DESK, 2-DOOR/2-DRAWER CABINET, 36" DIAMETER TABLE, (2) LEATHER CHAIRS)	593	1	64" PANASONIC VIERRA FLATSCREEN TV
		CONTINUE BACK TO MAIN BUILDING TOWARD COURTYARD	594	1	(LOT) (2) NEC OVERHEAD PROJECTORS AND (2) MOTORIZED SCREENS
564	1	(LOT) (2) LEATHER LOVE SEATS, COFFEE TABLE	594A	1	IPAD ON WALL
565	4	(LOT) (4) CLOTH CHAIRS	595	1	(LOT) (5) FATIGUE MATS
565A	1	(LOT) (4) PATIO TABLE UMBRELLAS	596	1	48" NEC FLAT SCREEN TELEVISION
565B	1	(LOT) (4) PATIO TABLE UMBRELLAS	597	1	MICHAEL BLASER "VIEW OF COVINGTON" SIGNED AND NUMBERED LITHOGRAPH
565C	1	(LOT) (4) OUTDOOR SPEAKERS	598	9	PRINTS AND PICTURES
		IN MAIN HALLWAY BY COURTYARD	599	10	PRINTS AND PICTURES
566	1	(LOT) (6) 30" X 30" TABLES	600	9	PRINTS AND PICTURES
567	1	(LOT) (5) 36" DIAMETER AND (1) 30" X 30" TABLES	601	10	PRINTS AND PICTURES
568	5	TRASH RECEPTACLES	602	10	PRINTS AND PICTURES
569	6	TRASH RECEPTACLES	603	10	PRINTS AND PICTURES
570	4	66" BENCHES	604	9	PRINTS AND PICTURES
571	1	(LOT) CLOTH COUCH AND COFFEE TABLE	605	8	MIRRORS
572	2	CLOTH LOVE SEATS	606	10	MIRRORS
573	2	10-DRAWER HARDWARE CABINETS WITH CONTENTS, in closet	607	10	PRINTS AND PICTURES
		LARGE BREAKROOM IN MIDDLE OF BUILDING	608	10	PRINTS AND PICTURES
574	10	5' PORTABLE TRAINING ROOM TABLES WITH ELECTRIC OUTLET	609	10	PRINTS AND PICTURES
575	10	5' PORTABLE TRAINING ROOM TABLES WITH ELECTRIC OUTLET	610	9	PRINTS AND PICTURES
576	3	36" X 36" TABLES	611	10	FRAMED PHOTOS
578	3	36" DIAMETER PORTABLE TABLES	612	9	PRINTS AND PICTURES
579	8	5' PORTABLE TRAINING TABLES	613	10	MIRRORS
580	8	5' PORTABLE TRAINING TABLES	614	13	PRINTS AND PICTURES
581	8	5' PORTABLE TRAINING TABLES	615	1	(LOT) (10) MISCELLANEOUS CLOCKS
582	8	5' PORTABLE TRAINING TABLES	616	2	WASTE RECEPTACLES
583	3	5' PORTABLE TRAINING TABLES	616A	1	LOT) (2) 24" X 48" FORMICA CONDIMENT STATIONS
584	10	5' FOLD UP PORTABLE TABLE	617	1	(LOT) MISCELLANEOUS CONTENTS OF ROOM LIGHTING, KNICKKNACKS, ELECTRONICS, OFFICE SUPPLIES
585	10	5' FOLD UP PORTABLE TABLE			***DOWN MAIN HALLWAY ON WEST SIDE OF BUILDING TO LARGE ROOM JUST BEFORE GOING IN TO PLANT ON RIGHT***
586	9	CHAIRS	618	1	14-STATION KARDEX LEKTREIVER VERTICAL CAROUSEL **Loading Fee Due the "ERRA" Hosea Project Movers \$400.00, SEE PRICING SPECIFICS**
587	7	CHAIRS			
588	4	ELECTROLUX AND MAGIC CHEF MINI REFRIGERATORS			

Catalog for Auction:Direct Mail, Distribution Center

Lot Num	Qty.	Description	Lot Num	Qty.	Description
619	1	14-STATION WHITE POWER FILE VERTICAL CAROUSEL **Loading Fee Due the "ERRA" Hosea Project Movers \$400.00, SEE PRICING SPECIFICS**	647	1	(LOT) U SHAPED DESK, ROUND TABLE W/ (3) CHAIRS, (2) LATERAL FILES, AND (5) MISCELLANEOUS CHAIRS
620	10	SECTIONS MISCELLANEOUS STEEL SHELVES	648	1	(LOT) SUPPLIES IN ELECTRICAL STORAGE CLOSET, NO BUILDING FIXTURES, BUYER MUST LEAVE IN ORDERLY FASHION
621	1	(LOT) (4) 3' SHOP LADDERS ***GO IN TO PLANT, HEAD DOWN AISLEWAY TOWARD EAST SIDE OF BUILDING TO OFFICE AREA ON RIGHT***	649	1	52" TRUE DOUBLE DOOR COCA COLA BRANDED REFRIGERATOR
622	1	HP LASERJET M4345 MFP COPIER/PRINTER	650	1	90" LAMBERTSON 3-BOWL STAINLESS STEEL SINK
623	2	HP LASERJET 9000DN PRINTER AND HP COLOR LASER JET 4700N COPIER	651	1	21" X 27" KENMORE CHEST TYPE FREEZER
624	2	HP LASERJET M4345 MFP COPIER/PRINTERS	652	1	(LOT) PAPER FORGEIGN CURRENCY, located in auction office ***Subject to Bid Confirmation***
625	2	HP LASERJET ENTERPRISE MFP M527 COPIER/PRINTERS	653	1	(LOT) COIN FORGEIGN CURRENCY, located in auction office ***Subject to Bid Confirmation***
626	2	HP LASERJET PRO 500 COLOR MFP AND LASERJET M3035 MFP COPIER/PRINTERS			
627	2	HP COLOR LASERJET CP4525 AND LASERJET P4015N PRINTERS			
627A	1	HP LASERJET M4345 PRINTER			
628	2	HP LASERJET 4250TN AND 4350DN PRINTERS			
629	3	HP LASERJET 4250TN PRINTERS			
630	2	HP LASERJET 4200TN PRINTERS			
631	2	HP LASERJET PRO400 COLOR MFP AND PRO MFP M426FDN PRINTER			
632	3	HP LASERJET P4015N, P4015DN, 4050T PRINTERS			
633	3	VARIDESK STANDING DESKS			
634	3	VARIDESK STANDING DESKS			
635	3	VARIDESK STANDING DESKS			
636	3	MISCELLANEOUS STANDING DESKS			
637	1	TEKTRONIX MODEL T912 10MHZ STORAGE OSCILLOSCOPE			
638	1	100 LB. CAP DIGI POSTAL DIGITAL SCALE			
639	1	30 LB. CAP FRIDEN/NEOPOST DIGITAL MAIL SCALE			
640	1	84" X 78" L-SHAPED DESK			
641	2	4-DRAWER AND 2-DRAWER FILE CABINETS			
642	1	96" STEEL POSTAL BENCH			
643	2	48" X 36" PORTABLE WOOD CARTS			
644	1	(LOT) (4) 30" X 30" STEEL PATIO TABLE AND (16) STEEL CHAIRS			
645	1	18' X 21' STEEL CARPORT			
646	1	KENMORE SINGLE DOOR REFRIGERATOR			