



Buncombe County Assessment Property Record Search

BUNCOMBE COUNTY ASSESSMENT PROPERTY RECORD SEARCH

965849277400000
39 WAKE ROBIN WAY

LOIS WILLIAMS ETAL UI
C/O LOIS WILLIAMS, BLACK MTN, NC, 28711

Total Appraised Value
\$234,000

Key Information

Zoning	RM6	Neighborhood	STMA
Land Use Code	RES	Municipality	CAS
Fire District	-	Special District	-
Present Use	-	Appraisal Area	A
Exemption	-		
Legal Description	Deed Date: 09/03/1996 Deed: 1923-0515 Subdiv: SPRINGTIME Block: C Lot: 6 Section: 1 Plat: 0034-0079		
Plat Reference	34-79		

Assessment Details

Land Value	\$43,200
Building Value	\$190,800
Features	\$0
Total Appraised Value	\$234,000
Deferred Value	\$0
Exempt Value	\$0
Total Taxable Value	\$234,000

LAND INFORMATION

ZONING	LAND USE CODE	SIZE	NEIGHBORHOOD	ASSESSED VALUE	FLOODPLAIN
RES MULTI FAM LOW DENSITY	RES	0.38 acres	STMA	\$43,200	NO

BUILDING INFORMATION

Building(s)

▼ Building (1)

Quality	AVG	Condition	NORMAL
Building Type	BI-LEVEL	Year Built	1967
Full Baths	1	Half Baths	1
Fireplaces	0	Story	1.00
Heat Type	HEAT NO A/C	Green Certification	
Style	BI-LEVEL	Base	1269
Bedrooms	4	Deck	200
Patio	548	Carport	0
Garage	0	Utility	0
Unfinished Basement	0	Finished Basement	1269
Porch	0		

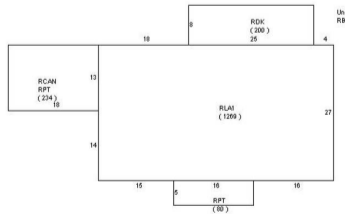

TRANSFER HISTORY

TRANSFER DATE	TRANSACTION PRICE	VALID SALE	BOOK / PAGE	DEED INSTRUMENT
1996-09-03	\$0	Not Qualified	1923-515	WDT

VALUE CHANGE HISTORY

DATE OF VALUE CHANGE	EFFECTIVE TAX YEAR	REASON FOR CHANGE	NEW VALUE
2017-01-27	2017	RAPP REAPPRAISAL NOTICE	\$234,000

RECENT PERMIT ACTIVITY
No data to display

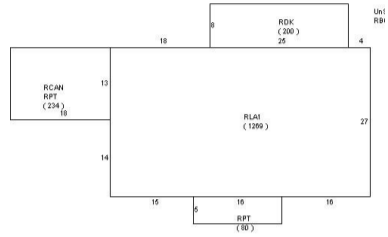
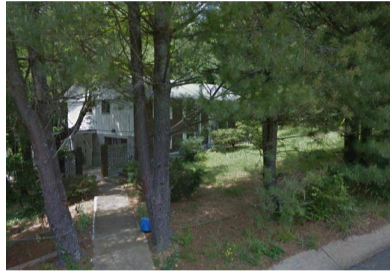

Developed for Buncombe County Assessment Property Record Search by

Data last updated: 07/31/2020