

# Trigg County, KY PVA

## Parcel Summary

**Map Number** 46-049  
**Account Number** 220017 (PID: 668100 PTID: 220017)  
**Location Address** 670 SAMSIL CEMETERY RD  
**Homestead** No  
**Tax District** 00 County Only  
**Class** FARM  
**Description** THOMPSON LAND 107 ACRES  
**Acres** 107  
**Last Sale Date** 4/5/2011  
**Last Sale Price** \$0  
**Deed Information** 262/218

[View Map](#)



## Owner Information

**Current Owner**  
 BRANDON O D  
 % BRAXTON MARTHA  
 653 HUNTERS LN  
 HOPKINSVILLE, KY 42240

## Land Information

Lot Size	Lot Frontage	Lot Depth	Acreage	Street Type	Driveway	Neighborhood Type	Site Condition	Land Value
			107.00	SECONDARY	GRAVEL	TYPICAL	AVERAGE	\$428,000

## Residential Improvement Information

<b>Building</b>	1	<b>Heat</b>	STOVE/SPACE HTR
<b>Residence Type</b>	SINGLE FAMILY	<b>AC</b>	OTHER
<b>Year Built</b>	1914	<b>Total Rooms</b>	3
<b>Foundation</b>	POST & PIER	<b>Value</b>	\$12,397
<b>Basement</b>	NONE	<b>Living Sqft</b>	704
<b>Exterior</b>	FRAME	<b>Basement Sqft</b>	0
<b>Bedrooms</b>	1	<b>Garage Sqft</b>	0
<b>Full Bath</b>	1	<b>Porch Sqft</b>	288
<b>Half Bath</b>	0	<b>Patio/Deck Sqft</b>	0
<b>Roof Cover</b>	METAL	<b>Basement Finish</b>	
<b>Roof Type</b>	GABLE	<b>Structure</b>	1.5 STORY
<b>Residence Condition</b>	GOOD	<b>Garage</b>	NONE
<b>Fireplaces</b>	0	<b>Pool</b>	

## Sales Information

Sale Date	Sale Price	Deed Book	Deed Page	Previous Owner	Sale Type
04/05/2011		262	218	THOMPSON I V -EST-	

## Valuation

	2024
Homestead	No
FRM_FCV	\$440,397
FRM_TXV	\$26,125
FRM_RES	\$12,397
FRM_AC	\$107
FIRE_AC	\$107
045_FIRE	\$30
PREV_ASST	\$31,000
<b>Taxable Value</b>	<b>\$26,125</b>

## Photos

## Sketches

Sketch Summary

LivingArea=704.00  
Porch=288.00

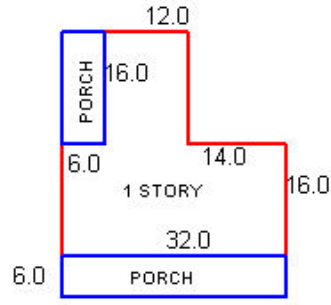

Scale: 1 inch = 30.0

Recent Sales In Area

Sale date range:

From: 11 / 20 / 2020 To: 11 / 20 / 2023

Sales by Neighborhood

Sales by Subdivision

1500

Feet



Sales by Distance

No data available for the following modules: Commercial Improvement Information, Mobile Home Information.

Trigg County makes every effort to produce the most accurate information possible. No warranties, expressed or implied, are provided for the data herein, its use or interpretation. The assessment information is from the last certified taxroll. All data is subject to change before the next certified taxroll.

[User Privacy Policy](#) | [GDPR Privacy Notice](#)  
Last Data Upload: 11/18/2023, 12:19:59 AM

Contact Us

Developed by  
 Schneider  
GEOSPATIAL