

Summary

Map Number/Account Number 233-00 04 055.00 / 175980001
Tax District City of Hopkinsville (01)
Description 422 CARDINAL DR L12&14 BL B CO CLUB EST
 (Note: Not to be used on legal documents)
Tax Rates [See Tax Rates](#)
Location Address 422 CARDINAL DR
Deed Book 551
Deed Page 084

[View Map](#)



Owner

Duncan William G Family Trust
 422 Cardinal Dr
 Hopkinsville KY 42240

Value Information

	2022 Working Tax Roll Assessment	2021 Certified Tax Roll Assessment
Residential Value	\$317,500	\$317,500
Commercial Value	\$0	\$0
Mobile Home Value	\$0	\$0
Farm Tax Value	\$0	\$0
Farm Fair Cash Value	\$0	\$0
TC Build Value	\$0	\$0
TC Land Value	\$0	\$0
LS Hold Value	\$0	\$0
Homestead	Yes	Yes

Most Recent Sale

Sale Date	Sale Price	Deed Book	Deed Page	Previous Owner
9/1/1998	\$317,500	551	084	DUNCAN GRAHAM HEIRS

Land Information

Class	RESIDENTIAL	Sidewalks	
Lot Size	51000	Topography	
Frontage	150	Zoning Code	
Depth	340	Subdivision	COUNTRY CLUB EST
Acreage	0	Unit	
Type	RESIDENTIAL	Block	B
Drive Type	A	Lot	12&14
Flood Type		Land Value	\$0
Utility Type			

Residential Improvement Information

Res Type	SINGLE FMLY	Heat	GAS
Year Built	1960	AC	CENTRAL
Foundation	BRICK ON BLOCK	Total Rooms	0
Basement	WALKOUT	Value	\$0
Exterior	BRICK	Living Sqft	2944
Bedrooms	3	Basement Sqft	2300
Full Bath	2	Garage Sqft	520
Half Bath	0	Porch Sqft	0
Roof Cover	CPSN SHGLS	Patio/Deck Sqft	0
Roof Type	GABLE	Basement Finish	0
Res Cond		Structure	1 STORY
Fireplaces	1	Garage	ATTCHD 2 CAR

Sale Information

Sale Date	Sale Price	Deed Book	Deed Page	Previous Owner
9/1/1998	\$317,500			MCCOY HAL H
12/1/1992	\$185,000			THOMAS GEORGE W SR

Recent Sales In Area

Sale date range:

From: 01 / 01 / 2013 To: 05 / 11 / 2022

Recent Sales in Area

1500

Feet



Sales by Distance

Photos



Sketches

2300 SQ FT IN BASEMENT

Sketch Summary

GroundLiving=2944.00
Garage=520.00

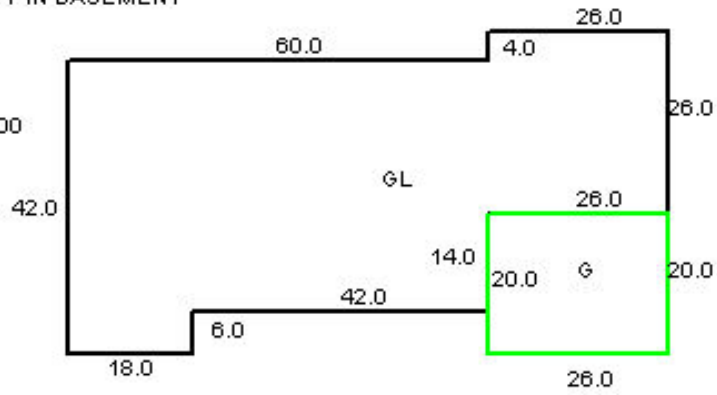

Scale: 1 inch = 30.0

No data available for the following modules: Mobile Home Information, Commercial Information.

The Christian County Assessor's Office makes every effort to produce the most accurate information possible. No warranties, expressed or implied, are provided for the data herein, its use or interpretation.

[User Privacy Policy](#)
[GDPR Privacy Notice](#)

Last Data Upload: 3/25/2022, 12:22:03 PM

Developed by
 Schneider
GEOSPATIAL

Version 2.3.194