



Christian County, KY PVA

Summary

Map Number/Account Number 248-00 03 042.00 / 111632701
Tax District City of Hopkinsville (01)
Description 1205 SHALLOW LAKE L25 GREAT OAKS BL 1
 (Note: Not to be used on legal documents)
Tax Rates [See Tax Rates](#)
Location Address 1205 SHALLOW LAKE CIR
Deed Book WB79
Deed Page 384

[View Map](#)



Owner

Champion Vicki D & Larry E Webb
 2915 Cox Mill Rd Apt L6
 Hopkinsville KY 42240

Value Information

	2022 Working Tax Roll Assessment	2021 Certified Tax Roll Assessment
Residential Value	\$195,000	\$195,000
Commercial Value	\$0	\$0
Mobile Home Value	\$0	\$0
Farm Tax Value	\$0	\$0
Farm Fair Cash Value	\$0	\$0
TC Build Value	\$0	\$0
TC Land Value	\$0	\$0
LS Hold Value	\$0	\$0
Homestead	No	Yes

Most Recent Sale

Sale Date	Sale Price	Deed Book	Deed Page	Previous Owner
12/2/2021	\$0	WB79	384	WEBB DOROTHY J

Land Information

Class	RESIDENTIAL	Sidewalks	N
Lot Size	0	Topography	LEVEL
Frontage	0	Zoning Code	
Depth	0	Subdivision	GREAT OAKS
Acreage	0	Unit	
Type	RESIDENTIAL	Block	
Drive Type	A	Lot	25
Flood Type	N	Land Value	\$0
Utility Type	W		

Residential Improvement Information

Res Type	SINGLE FMLY	Heat	HEAT PUMP
Year Built	1981	AC	CENTRAL
Foundation	BRICK ON BLOCK	Total Rooms	0
Basement	NONE	Value	\$0
Exterior	BRICK	Living Sqft	2080
Bedrooms	4	Basement Sqft	0
Full Bath	3	Garage Sqft	660
Half Bath	1	Porch Sqft	0
Roof Cover	CPSN SHGLS	Patio/Deck Sqft	0
Roof Type	GABLE	Basement Finish	0
Res Cond		Structure	1 STORY
Fireplaces	1	Garage	ATTCHD 2 CAR

Sale Information

Sale Date	Sale Price	Deed Book	Deed Page	Previous Owner
12/2/2021	\$0	WB79	384	WEBB DOROTHY J
5/1/1996	\$175,000			RAMIREZ DAVID G
9/1/1993	\$159,900			PAUL M TAYLOR

Recent Sales In Area

Sale date range:

From:

01/01/2013

To:

04/13/2022

1500

Feet

Photos



Sketches

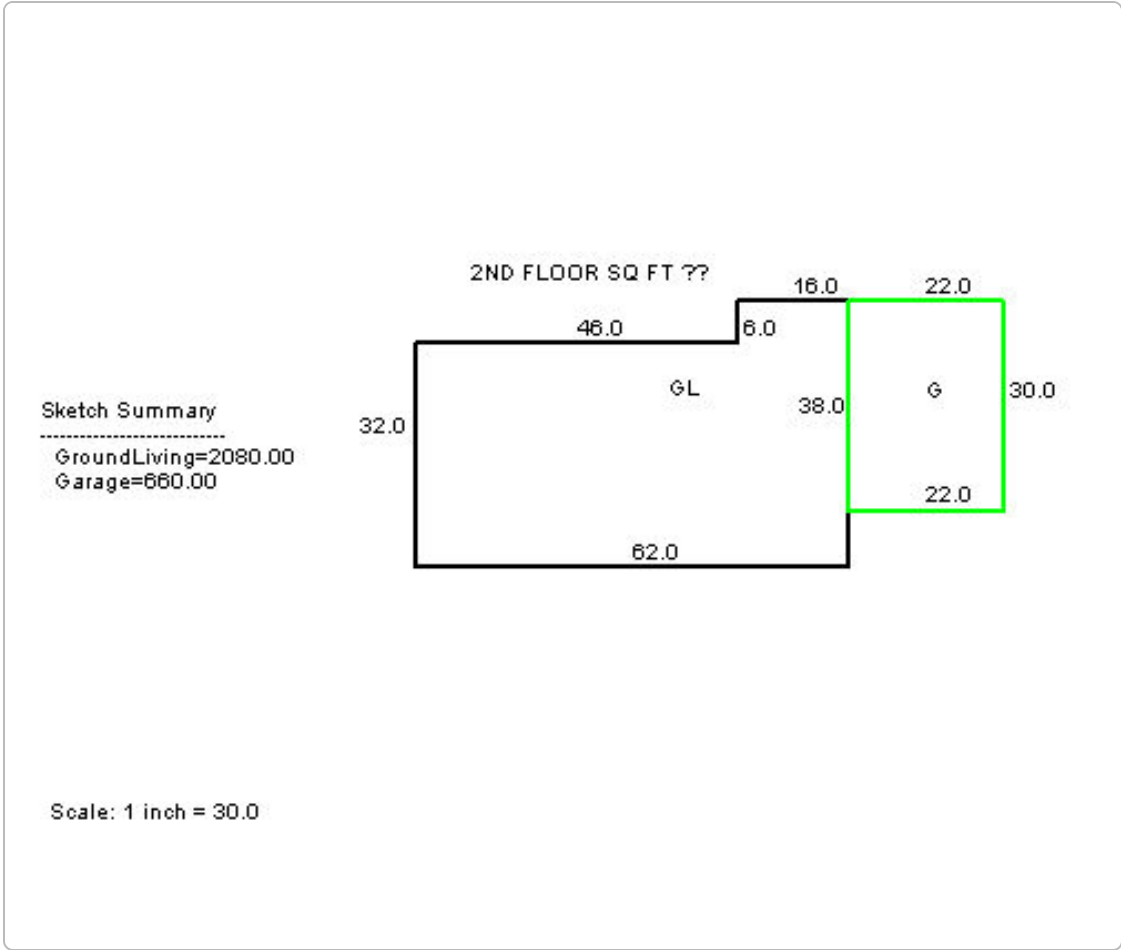

No data available for the following modules: Mobile Home Information, Commercial Information.

[User Privacy Policy](#)
[GDPR Privacy Notice](#)
[Last Data Upload: 3/25/2022, 12:22:03 PM](#)

