

Summary

Parcel Number MGAP-22-21
 Account Number 18896
 Location Address MORTON ST 00145
 Description (Note: Not to be used on legal documents)
 Class Residential
 Tax District 05 Mortons Gap
 2018 Rate Per Thousand 10.1410

[View Map](#)



Owner

Primary Owner
 RICHARDSON DAVID E & MARTHA (D)
 145 MORTON ST
 MORTONS GAP, KY 42440

Land Characteristics

Condition	Good	Topography	Level
Plat Book/Page		Drainage	
Subdivision		Flood Hazard	
Lot		Zoning	Residential
Block		Electric	Yes
Acres	0.34	Water	Yes
Front	75	Gas	No
Depth	200	Sewer	Yes
Lot Size	75X200	Road	Secondary
Lot Sq Ft	0	Sidewalks	No
Shape		Information Source	Deed

Valuation

	2022 Working	2021 Certified	2020 Certified	2019 Certified
+ Land Value	\$5,900	\$5,900	\$5,900	\$5,900
+ Improvement Value	\$107,000	\$107,000	\$91,200	\$91,200
+ Ag Improvement Value	\$0	\$0	\$0	\$0
= Total Taxable Value	\$112,900	\$112,900	\$97,100	\$97,100
- Exemption Value	\$0	\$0	(\$39,300)	(\$39,300)
= Net Taxable Value	\$112,900	\$112,900	\$57,800	\$57,800
+ Land FCV	\$0	\$0	\$0	\$0
+ Improvement FCV	\$0	\$0	\$0	\$0
+ Ag Improvement FCV	\$0	\$0	\$0	\$0
= Total FCV	\$0	\$0	\$0	\$0
Exemption			HX	HX
Farm Acres	0.00	0.00	0.00	0.00
Fire Protection Acres	0.00	0.00	0.00	0.00

Taxes

	2020	2019
Tax	\$586.17	\$586.17

Improvement Information

Building Number	1	Kitchens	0
Description	HOUSE & DET GAR	Dining Rooms	0
Residence Type	Single Family	Living Rooms	0
Comm Type		Family Rooms	0
Mobile Home Type		Bedrooms	3
Year Built	2010	Full Baths	2
Effective Age	0	Half Baths	0
Ave. Wall Height	0	Other Rooms	0
Structure	1 Story	Total Rooms	0
Number of Stories	0	Living Sq Ft	1,216
Exterior	Vinyl	Fireplaces/Water	0/1
Foundation	Concrete Block	Supplemental Heat	
Construction Type	Wood Frame	Mobile Home Model	
Construction Quality	Average/Standard	Mobile Home Manufacturer	
Building Condition	Good	MH Skirt Foundation	
Roof Type	Gable	Heat	Yes
Roof Cover	Comp.Shingles	Heat Source	
Roof Pitch	Medium	Heat Type	Forced Air
Basement Type		Air Conditioning	Yes
Basement Finish		AC/Type	Central
Basement Size		Special Improvements	No
Basement Sq Ft	0	Fire Alarm	No
Garage/Carport	Garage	Sprinklers	No
Garage Size	2 Car	Porch/Deck	
Garage Type	Detached	Porch Sq Ft	64
Garage Exterior	Vinyl	Deck Sq Ft	0
Width	20	Concrete Sq Ft	0
Length	20	Farm Bldg Type	
Garage Sq Ft	352	Value	\$107,000.00
Pool		Driveway	Paved/Asphalt
Pool Size	0	Fence	0
Tennis Courts			

Photos



Sketches

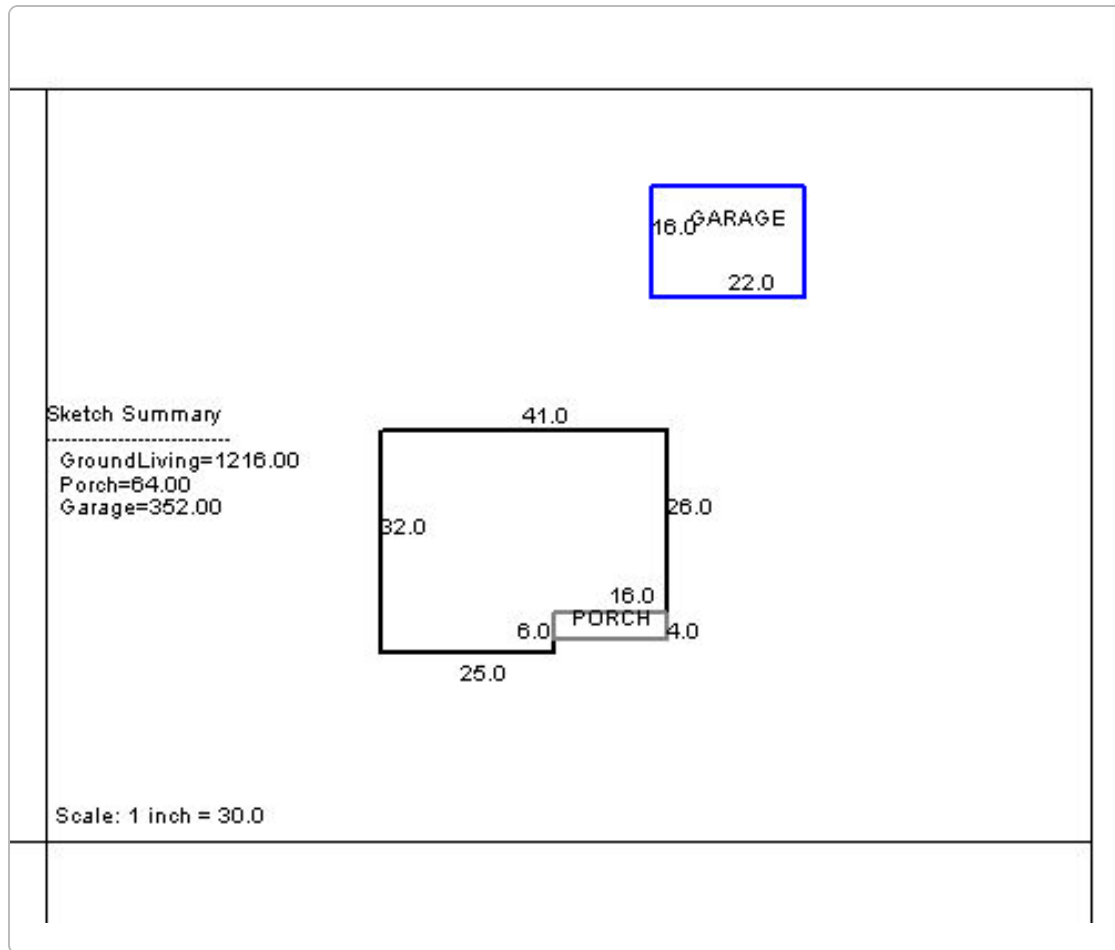

Sale Information

Sale Date	Sale Price	Sale Type	Book-Page	Grantee	Grantor
8/1/1956	\$0		242-439	RICHARDSON DAVID E & MARTHA	

The Hopkins County Property Valuation Administrator's Office makes every effort to produce the most accurate information possible. No warranties, expressed or implied, are provided for the data herein, its use or interpretation. The assessment information is from the last certified taxroll. All data is subject to change before the next certified taxroll.
[User Privacy Policy](#)
[GDPR Privacy Notice](#)



Last Data Upload: 11/4/2021, 2:12:45 PM

Version 2.3.158