

Report of Survey prepared for
Jocanne Dawe
 of lands retained by
Geneva Vollmar
 being part of the Southeast and Southwest 1/4
 of Section 27, Town 6 North, Range 9 East,
 Providence Township, Lucas County, Ohio

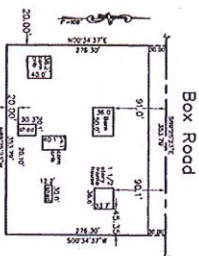

Box Road
 DETAIL
 Split Parcel Box Road



M. FREELS SURVEY CO., LLC
 5225 SECOR ROAD UNIT 10 TOLEDO, OHIO 43623
 SOLO VOLVIS
 DATE: 1/11/07
 VOLLMAR/Dawe
 00-0048

F-825