

LOT 10

LOT 11

LOT 12

IRF N 38°22'00"E 250.00' IRF

LOT 3  
3.0016 AC.

DB 394  
PG. 165

LOT 2

N 51°36'00"W 523.00'

S 51°36'00"E 523.00'

LOT 4

PROPOSED HOUSE SITE

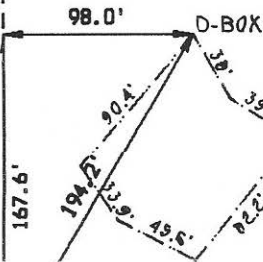

PROPOSED DRAINFIELD SITE

WELL SITE  
44.7'

480.4' TO PC  
HENRY DRIVE

IRF S 38°22'00"W 250.00' IRF

CARDINAL DRIVE  
40' R/W



DRAINFIELD LOCATION SURVEY  
LOT 3 BLOCK D SECTION 9  
MOUNTAIN FALLS PARK  
BACK CREEK DISTRICT  
FREDERICK COUNTY, VIRGINIA

FURSTENAU SURVEYING (540) 662-9323  
111 SOUTH LOUDOUN STREET  
WINCHESTER, VIRGINIA 22601

DATE: FEBR. 9, 2005

SCALE: 1" = 100'

W.O. 0030  
TM 58AI-D-9-3

EST. 1986

MEMBER VA. ASSOC. OF SURVEYORS